

USER MANUAL



by **femkes**

Getting started

Congratulations, you've bought a femkes rooftop! Please check if the following items are included when opening your box:

- ① Flexible poles 4.
- ② Mounting set in a bag.
- ③ 1 telescopic 2.3 m ladder in a bag.
- ④ 1 shoe bag and 1 accessory bag.
- ⑤ 2 caravan rails (attached to the shell) for annex awning.
- ⑥ 3D mesh under the mattress.
- ⑦ 2 luggage nets inside the roof.
- ⑧ 2 ladder brackets to mount to the bottom plate of the tent.
- ⑨ Shell protection cover (see tips and tricks #8).
- ⑩ Raptor covered shell.

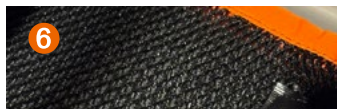

How to mount your rooftop tent

- Open the box.
- Remove the shell cover and foam.
- Place your tent on the cross bars of your car.
- Centre the tent on top of your car.
- 1 Insert two sliders with bolts into the front of the rail and lift the tent to slide them across the cross bar.
- 2 Insert second slider with bolt.
- Step and repeat for the back of the rail.
- 3 Add the brackets to the bolts.
- 4 Connect the nuts but not too tight yet.
- Check if tent is centred properly.
- Use the spanner to tighten the nuts, front first.
- Then tighten the nuts on the back of the rail.

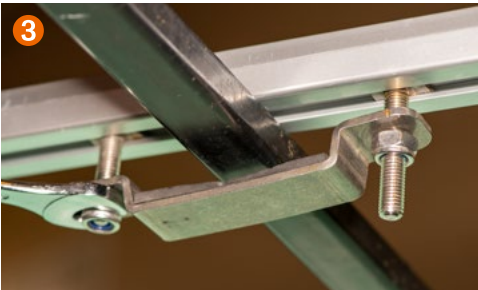

IMPORTANT

- Tighten the two bolts simultaneously per cross bar.
- Don't tighten too far.
- The mounting bracket needs to stay horizontal and shouldn't bend.
- Double check all the bolts.
- Check again after the first 100 kms of driving.
- Repeat regularly.
- Keep all screws and bolts clean and serviced with WD40.
- Decide on which side of the car you would like to enter the tent, this is the side you will need to mount the ladder brackets.
- To mount the brackets, remove the rubber caps from the inside of the tent. Insert the bolts from the top down. Mount the bracket under the bottom plate and secure with the bolts.

Opening your hardshell tent

- 1 Open the tent by unlocking the 2 straps and Velcro on either side of the tent.
 - 2 When all closures are unlocked, push the shell up horizontally on one side of the car. The gas struts will help elevate the shell.
 - 3 Install the 2 brackets to the bottom plate of the tent on your favorite entry side, using the pre-drilled holes in the bottom plate.
 - 4 Remove the ladder from your tent by opening the 4 buckles inside the tent for positioning during transportation.
 - 5 Remove the ladder bag and keep this bag dry and clean at all times.
 - 6 Undo the Velcro strap (first time only).
 - 7 Hang the ladder in the brackets, hold the top steps and pull out the steps needed to reach the ground.
 - 8 Securely install the ladder to the right height at an approx. 70 degrees angle.
- 2 Loosen the elastic band and tighten again when you intend to close the tent.

OPERATION OF THE LADDER

CAUTION! Failure to properly secure the ladder could cause serious injury. Read the next steps carefully before attempting to use the ladder.

- Depending on the height of your car, hold 3-4 rungs at the top and pull out the bottom rungs until they reach the ground.
- If you have a low car, you might need to hold 5 rungs. If you are on a high car, you only might need to hold 2 rungs or less.
- It is also possible to lock the steps by half a rung.
- Make sure the ladder is placed on even, solid ground. Do not install the ladder on uneven or sandy/muddy ground.
- Place the ladder firmly at an approximate 70 degrees angle.
- The ladder should not be installed and used in a vertical position, always at a slight angle for better support.
- Before entering the tent, check if every rung is secured. Use two hands to climb up, one step at a time.
- Be aware of the sharp corners of your ladder steps and make sure there is enough distance between the ladder and your vehicle.



Setting up your bedroom

- 1 Climb halfway up the ladder, insert the flex poles horizontally into the holes on both sides of the ladder, in the bottom plate.
- Use the other hand to grab the top of the awning and insert the pole into the O-ring overhead in both corners of the awning. **Please note**, the holes for the flex poles are at an angle.
- Make your bed and note that you can leave your pillows inside. Leave bedding as flat as possible when closing the shell.

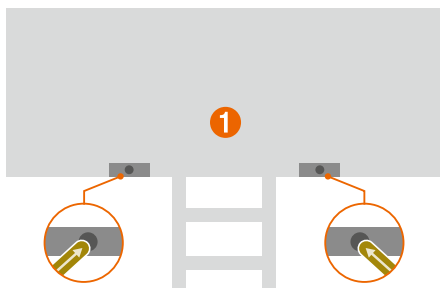

Closing the rooftop tent

- Flatten your sleeping bags and pillows in the tent.
- Remove the flex poles and put them in the bag and store in the tent.
- Remove the ladder from the brackets.
- Shorten the ladder and place the ladder back in the dry and clean storage bag.
- Take the elastic strap and loop the strap around the tent. Tighten as much as possible to enable the fabric to fold in.
- Pull the long black nylon strap down horizontally, on your favorite side of the car.
- Tuck the fabric sticking out into the tent and also don't forget to push the nylon strap under the shell.
- Use the Velcro straps to keep the shell almost closed. Once the shell is closed, use the handle to pull down the shell and close the reinforced straps.
- If you have difficulties closing the shell, you may have left too much bedding in the tent. Or you might have closed all the zippers. In this case, remove some of the bedding and open zippers as air needs to flow out and give it another try.
- Use the handle or your flat hand on top of the shell to pull the shell down. Don't pull at the locks or rubber band.

Watch your tutorial on
femkesrooftoptents
website



Tips and tricks

Some of our tips and tricks:

- 1 Elastic strap for easy closure, be careful not to let go if you are setting up together, it will hurt.
- 2 RVS plates for extra strength and depth for the flex poles you will need to set up the small awnings over your entrance. Push deep, you'll hear a 'click' when you reach the end.
- 3 Please note, the holes for the flex poles are at an angle and poles must be pushed in horizontally at the right angle for stability of the awning.
- 4 We have added a small rubber ring to the flex poles, this will ensure that raindrops will fall when reaching the ring instead of making the fabric wet.
- 5 Lifun offers the option to enter the tent on both sides. Only one set of ladder brackets is provided, an extra set can be bought for both sides.
- 6 For Lifun 2 bags are included, 1 for shoes and 1 for accessories. Extra bags can be bought if required.

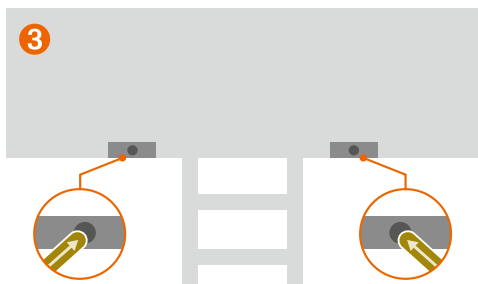
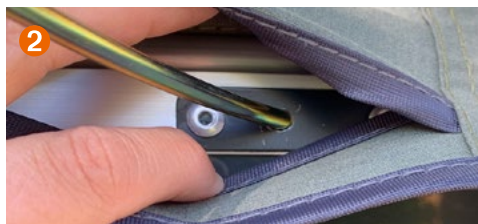

7 One annex awning is provided which can be mounted to the shell via a caravan rail. Telescopic poles, ropes and pegs are not included.

8 A shell protection cover is provided for winter storage but can also be used to protect your shell, while camping, for UV radiation, bird poo or sap from the trees.

9 Mesh windows can be completely opened. Tip! Roll them up to avoid them getting damaged.

10 Both straps for closing the tent can be rolled up when one of them is not being used. A velcro strap is provided to secure them under the shell.

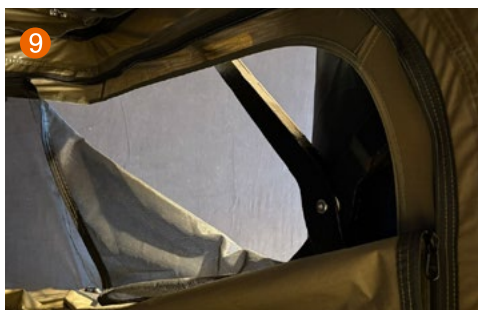

WARNING

- The rooftop tent needs to be mounted and connected to roofbars or roof rack prior to climbing into the rooftop tent.
- If you have any back, knee or other health issues, do not attempt to climb the tent on top of your vehicle.
- The crossbars must have a dynamic weight load of minimum 55 kg and must be at least 70 cm apart.
- Under no circumstances should any flame sources be used inside the tent.
- When camping, keep a safe distance with open fires in order to avoid airborne burning embers.
- Open the zippers by using the pullers, not by pulling or tearing at the fabric.

Accessories & maintenance

To upgrade your tent, we offer the following:



Anti-theft set of nuts and bolts M8



Extra ladder brackets available for multiple entry points



The Lifun wizzard awning does not include telescopic poles, guy ropes or pegs. The wizzard awning is two-sided black. Optional: magic curtains to close the awning can be set up on both sides of Lifun.



Winter liner

Maintenance

Your tent also needs maintenance, just like your car. Some love and care will help longevity.

- Always make sure the fabric of the tent and the mattress is dry before long term storage.
- Always ventilate well, especially in moist weather. Ventilation is important at all times.

- Keep all stainless steel and aluminium parts clean and spray them with WD40 regularly.
- The shell is covered by a Raptor liner. In case of damage or scratches, a new layer can be added.

More questions?

Please ask your local reseller

WARRANTY: We offer a 2 year warranty on all our rooftents. Warranty does not apply on zippers and other closures. Warranty does not apply for damage to the tent caused by any of the weather elements, wind or rain. Warranty does not apply caused by improper usage of the tent, i.e. forgetting to remove the rods from the gas struts inside the tent. As our products are assembled manually some tolerance needs to be taken into account. It is advisable not to compress, deform nor bend the upper shell. **Note:** the recommended maximum speed limit when driving with a rooftop tent on your vehicle is 120 km/h. Your driving speed should be adjusted according to the driving conditions, such as road type and road quality, weather (wind, rain or snow) and applicable speed limits. Decrease your speed for speed bumps and on bumpy roads.

by **femkes**
femkesrooftents.com