



Henleaze Christmas Festival 2025

*Prize Draw
in aid of
local charities
Tickets £2*

Entertainment, Children`s Rides
Santa and his Grotto
Stalls, Late Shopping

Wednesday 3rd December
4.00 pm - 8.00 pm



HenleazeChristmasFestival



HenleazeXmasFest

Proudly sponsored by

CJ HOLE
est. 1867



Welcome

Here we are again! It is 18 years since the first Henleaze Christmas Festival. A chance, once more, to enjoy what has become an annual community highlight of the festive season.

We are grateful for the continued support of our local shops and businesses. Without that support - donating raffle prizes, taking out advertising in this programme and in many cases supporting us on the night in different ways - there could be no festival.

A big thank you also to all of you who turn out on the night to take part in the evening. There will, as ever, be much to enjoy from the array of stalls to the variety of entertainment and the always popular children`s rides in Cardigan Road. And, yes, Father Christmas will be in his usual spot to welcome young visitors.

Our Prize Draw, as you will see on the opposite page, is a big part of the Festival and we hope as many of you as possible will buy a ticket or two with the chance of winning one of the fantastic prizes whilst supporting our three nominated charities.

CJ Hole, the local estate agents are again providing sponsorship of the Festival plus much needed help with setting up on the day. We are grateful for their continued support.

We always need more help to keep this popular event going for future years. If you can help, either by joining the planning committee or providing a helping hand on the night, please get in touch. Enjoy the evening!

Jane Emery, Festival Co-ordinator.
janeemery1951@gmail.com

Contents

Charity Prize Draw	3
Entertainment	8-9
Stalls	15
Programme and Map	20-21
Children`s Corner	25
Food Fest	31
Over the years	34
Useful Information	38

Charity Prize Draw

Your support for our Charity Prize Draw will be hugely appreciated. Tickets will be on sale at the Festival. There are stalls in Waterford Road and by the corner of Henley Grove.

Raising money for our annually nominated charities is an essential part of the Festival. It provides funds for some very worthy causes. If you haven't already bought a ticket now is your chance.

The three charities we are supporting this year are:



- **EveryFAMILY.** Providing support to Bristol families with children under five including health, education, and parental support and training.
www.everyfamily.org.uk
- **The Family Centre (Deaf Children).** Provides support, events and courses for deaf children and their families in and around Bristol. At family activities they welcome any family that has a deaf child or a deaf parent.
<https://fcdc.org.uk>
- **Vision Care for Homeless People.** Provides free eye care services to homeless and other vulnerable people in an accessible and friendly environment in which they feel safe, welcome and comfortable.
<https://www.visioncarecharity.org>

We are grateful to the local businesses who have donated the many prizes this year. Top prize will be a Christmas hamper.

**PLEASE
BRING
CASH**

Prize Draw tickets are £2 each and will be available in local shops in the run up to the Festival as well as from the ticket stalls on the night. We ask that you please pay with cash at the Prize Draw ticket stalls as there will be no card facility.



henleaze
DENTAL PRACTICE



General, Cosmetic and Restorative Dentistry in the Heart of Henleaze

Preventative Care
Crown & Bridgework
Cosmetic Treatments
Composite Bonding
Saturday Appointments

Dental Hygienists
Invisalign
Teeth Whitening
Friendly, Caring Staff
Easy Parking



Dr Mark Haseltine
B.D.S.
Dr Laura Birch
B.D.S MFDS RCSEd.
Dr Victoria Ward
B.D.S Hons.
Dr Ester Lucas
Lic Odont (Madrid).

130 Henleaze Road, Henleaze
Bristol, BS9 4LB

info@henleazedental.co.uk
www.henleazedental.co.uk
0117 962 0534



FINANCIAL CLARITY TODAY FOR THE LIFE YOU WANT TOMORROW

PLANNING

FOR A COMFORTABLE RETIREMENT

Whether you are contributing to existing pensions and savings, reviewing existing plans or already drawing an income, we can help you enjoy the retirement you deserve.

PLANNING

TAX EFFICIENT WAYS TO LEAVE MONEY TO YOUR FAMILY

If you are worried about inheritance tax, we can help you to explore and identify the best options to secure the financial future for your family.

Whatever your reason for wanting financial advice; planning for a comfortable retirement, receiving an inheritance or looking for the most tax efficient way to leave money to your family, we will provide you with financial clarity today, so you can live the life you want tomorrow.

Absolute Wealth Management offers independent financial advice. Call us on **0117 907 1965**, email us at **info@absolutewm.co.uk** or pop into our local office in Westbury Park.



**ABSOLUTE
WEALTH MANAGEMENT**

SAVINGS PENSIONS INVESTMENTS

41 North View, Westbury Park,
Bristol, BS6 7PY

T 0117 907 1965

www.absolutewm.co.uk

PARSONS BAKERY

PROUDLY SERVING THE PEOPLE OF HENLEAZE

OPEN MONDAY TO SATURDAY

ANY COFFEE £2.10

ANY PASTY £2.45

BACON SAUSAGE SARNIE & ANY HOT DRINK - £4.50

ANY COLD BAGUETTE. ANY CAKE. ANY DRINK - £4.95



FAMILY RUN 1926-2024. EMPLOYEE OWNED 2025

Lloyd`s Greengrocers

Manager: Paul Semple



81 Henleaze Road, BS9 4JP - Tel/Fax: 0117 962 3640



WARM YOURSELF AROUND OUR
LOG BURNER AND ENJOY A GLASS
OF MULLED CIDER AND A MINCE
PIE, WE'RE LOOKING FORWARD
TO MEETING YOU AT THE
HENLEAZE CHRISTMAS FESTIVAL.



**GOODMAN
& LILLEY**

T. 0117 213 0777
E. SALES@GOODMANLILLEY.CO.UK
WWW.GOODMANLILLEY.CO.UK



THE INDEPENDENT SALES, LETTINGS & LAND AGENTS
156 HENLEAZE ROAD, HENLEAZE, BRISTOL, BS9 4NB.

Entertainers

Steve Yabsley joins us again as our MC. Steve is a reporter, producer and presenter with BBC Radio Bristol. We are grateful to all our entertainers - both in the Outside Arena and at Trinity-Henleaze Church's Bradbury Hall. The entertainers perform free of charge and help create the festival's special vibrant atmosphere.



Henleaze Infant School Choir starts off the Festival again this year with a medley of festive songs which reflects the school's great tradition of music.

Storm Force 10 sing to keep the traditions of shanty alive, singing old standards and more unusual songs, some written by the crew. They like to have fun and enjoy the ongoing journey.



Dance Inspirations is a friendly and supportive dance school offering classes in ISTD ballet, modern, tap, contemporary and acro. Starting from 3 years old they hold lessons in Henleaze, Stoke Bishop and Redland.

Redmaids' High Junior School are excited to be returning to the Festival once again. The Junior String Group Wind Band and the Handbells team will be performing a selection of popular festive music.



Bristol A Cappella is an award-winning mixed barbershop chorus who love to sing close harmony a cappella! They are a diverse, inclusive and fun group who won gold at the British Association of Barbershop Singers in May 23.

The Mosaic Singers are a local singing group with a wide repertoire of popular music. ranging from Beach Boys medley, songs from musicals to familiar tunes from the movies.



Entertainers

St Ursula`s E-Act Academy Choir is a fun choir for children aged 7 to 11. They are a non-auditioned choir who rehearse once a week where they learn a wide range of music from traditional tunes to pop and folk songs.



Bristol Cantorion, formerly the Bristol Welsh Male Voice Choir, is a small group of men who enjoy singing not only Welsh songs but also songs in English and other languages too. You don't have to be a Welsh speaker, just enjoy singing.

Henleaze Junior School Choir is once again delighted to bring their ever-growing choir to perform at the Christmas Festival. The pupils have a proud passion for music and are very excited to share a rousing selection of festive songs.



Henleaze Choral Society.

A thriving local choir formed in 1972 performing mainly classical repertoire but with a passion for many musical genres.

Salvation Army Band is an ever popular addition to the evening. The band will be playing in the Arena and around the festival bringing their own special Christmas spirit.



Scottish Country Dancing. Bristol Westbury Scottish Country Dance Club and the Bristol branch of the Royal Sottish Country Dance Society look forward to showing how much fun they have dancing. Both BS9-based they welcome beginners and more experienced dancers for friendly classes and events.

Bristol Rock Choir Bristol Rock choir are a non auditioned group, with no experience needed. Our friendly choir sings pop and rock songs that everyone recognises.



Mevans Dance. Everyone is welcome to join our community: fun weekly classes, friendly monthly socials, performance workshops and stage shows. Make new friends. Something for everyone.

WARDS
SOLICITORS

120
YEARS
1905 - 2025

THE HENLEAZE TEAM WISH YOU ALL
A very
Merry Christmas
AND A HAPPY NEW YEAR



51 Henleaze Road, Henleaze, Bristol BS9 4JU
Tel: 0117 428 1999

Your local legal specialists wards.uk.com



Turners Opticians

Trusted Since 1939



MERRY CHRISTMAS
FROM
TURNERS OPTICIANS

Looking for Expert
Eye Care You Can Trust

&

Want To Look & Feel Great In Glasses?

Then We Are The Opticians For You!

57 Henleaze Road Bristol BS9 4JT 0117 9622 474
EyeCareTeam@turnersopticians.co.uk www.turnersopticians.co.uk

Turners Eye Care Ltd t/A Turners Opticians Incorporated in England & Wales Reg No. 8201460



Bouckley's
Hairdressing



Stockists
of
Moroccanoil
Redken
Joico

43 Henleaze Road, Bristol BS9 4JU
0117 962 3455

MERRY
Christmas

from your local property experts...

MAGGS
& ALLEN



Ready to sell in
2026?

60 Northumbria Drive
Henleaze, Bristol, BS9 4HW



maggsandallen.co.uk | 0117 949 9000



THE HENLEAZE SOCIETY

The Society was launched in 1973. The aim is to ensure that Henleaze remains a good place in which to live and work.

Key priorities include:

- Monitoring/assisting with planning applications.
- Environmental issues.
- Transport and highways.
- Managing member events such as the bi-annual Open Gardens day and an annual outing.
- Communicating local news through the Society's quarterly Newsletter, regular electronic updates, notice boards and website (www.henleazesociety.co.uk).

TO JOIN THE SOCIETY PLEASE COMPLETE THIS FORM:

I/we enclose an annual subscription of £5*
(or £7.50 if outside the Henleaze distribution area).

Cheques should be made payable to The Henleaze Society and sent to
Tony Thomas (Treasurer) at 8 Henley Grove, Bristol BS9 4EG.

Name(s) _____

Address _____

Postcode _____

Tel _____

Email _____

(*Membership is per household.) Registered Charity No. 269072.



Stalls

We're delighted to welcome back our very popular stall holders including many stalwarts and some returning after their first involvement last year.



There's plenty for everyone, in fact a regular smorgasbord of festive delights.

Choose from home-made sweet and savoury treats, mulled festive drinks, arts, crafts, plants, jewellery, toys, health giveaways and scores of gift ideas for those hard-to-buy-for friends and relatives.

The stalls will be spread as usual along Waterford Road and part of Dublin Crescent and on the corner of Henley Grove.

An advertisement for Henleaze Garden Shop. The top part features the shop's logo, which includes the name 'Henleaze Garden Shop' in a stylized font with colorful flowers. Below the logo are three social media icons: Facebook, Instagram, and Twitter. The background of the advertisement is a lush display of red and white flowers. At the bottom, there is a green banner with white text providing contact information.

COME AND SEE OUR RANGE OF GIFTS FROM SMALL TO TALL PLANTS, GIFT VOUCHERS, CHRISTMAS LIGHTS AND EVEN GIFTS FOR YOUR PETS AND SO MUCH MORE INC CHRISTMAS TREES.
CONTACT US ON 0117 9620148 OR EMAIL US AT EMAIL@HENLEAZEGARDENSHOP.CO.UK OR VISIT OUR WEBSITE WWW.HENLEAZEGARDENSHOP.CO.UK

VWV

Because life's
full of surprises,
we're here to help.

Conveyancing | Wills | Inheritance Tax Planning
Lasting Powers of Attorney

vww.co.uk



Win a Chandos Deli Christmas hamper

Pop into our Henleaze Road office before 12 December 2025
or scan the QR code to enter our free prize draw.

SEASON'S GREETINGS TO ALL OUR CUSTOMERS

**MON TO
FRI
8.30 AM
TO
5.45 PM**



**SAT
8.30 AM
TO
4.45 PM**

85 HENLEAZE ROAD



BADMINTON
SCHOOL

Start the journey



Prep School Open Morning
Friday 6th February

Pre-Reception & Reception 'Stay and Play'
Friday 13th February

NEW! Year 3 Scholarship available
for entry in September 2026



Scan to book your place

CHANDOS • DELI •

GREAT FOOD. PURE & SIMPLE

**JOIN US FOR A FABULOUS EVENING
OF DELICIOUS EXPERIENCES**

Spanish Chorizo Hot Dogs
Mulled Drinks
Samples and Tastings from local suppliers
Wine
Cheeses
Charcuterie
Olives

97 Henleaze Road, BS9 4JP



184 Henleaze road
Bristol
BS9 4NE

Merry Christmas

FROM TEAM
ELITE FINANCIAL ACCOUNTING

For help with your accountancy and tax needs.
Specialising in Property Tax, Inheritance Tax and
working with Freelancers.



Call 01172541166

Email: info@elitefinancialaccounting.com
www.elitefinancialaccounting.com

CAMERON LEE

CARPETS



© 2011 Cameron Lee Carpets & Floors Ltd
CRUCIAL TRADING

the first and last
name in high quality
floor coverings

88-91 Henleaze Road, Henleaze, Bristol BS9 1JP
Tel: 0117 9420984 www.cameronleecarpets.co.uk

Entertainment

Master of Ceremonies

Steve Yabsley of BBC Radio Bristol

Outside Arena in Waterford Road

4.00 pm	Henleaze Infant School Choir
4.15 pm	Henleaze Junior School Choir
4.30 pm	Arrival of Father Christmas
4.40 pm	Bristol A Cappella
5.10 pm	Bristol Cantorion
5.40 pm	The Mosaic Singers
6.10 pm	Henleaze Choral Society
6.40 pm	Storm Force 10
7.10 pm	Salvation Army

Bradbury Hall

Trinity-Henleaze URC

4.20 pm	St Ursula`s E-Act Academy Choir
4.45 pm	Red Maids` Junior High School
5.15 pm	Dance Inspirations
5.45 pm	Scottish Dancing
6.15 pm	Mevans Dance
6.45 pm	Bristol Rock Choir
4.00 -	Coffee Bar and Church Foyer - refreshments
7.00 pm	and Christmas craft activities for all ages.
4.00 -	Main Church - a chance for peace and space for
7.00 pm	your own thoughts with a variety of reflections, meditations, images and music.

St Peter`s Church

3.30 -	Nativity-themed craft and other activities which
6.30	all ages are welcome to join in with. Refreshments will also be available.

Festival Map

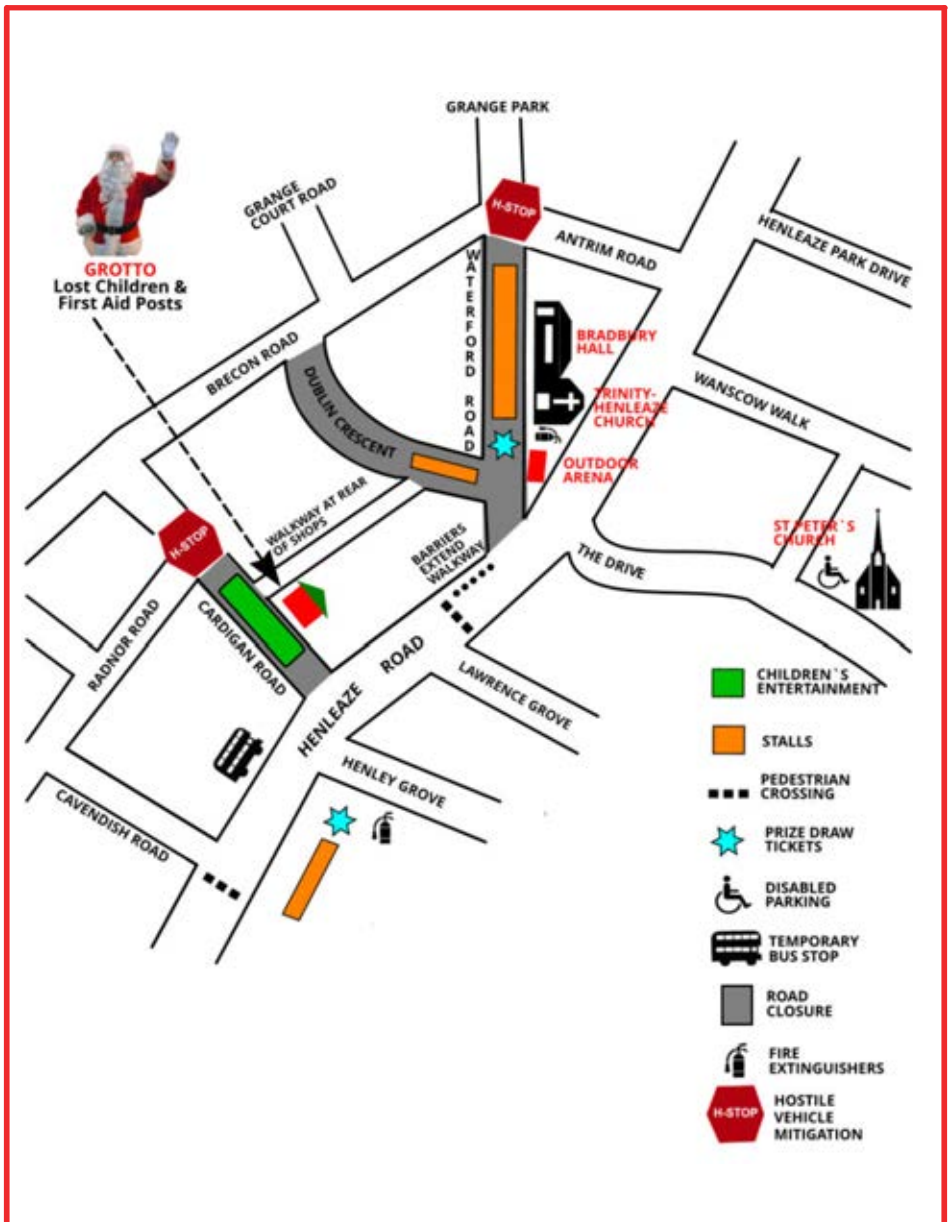

MERRY CHRISTMAS

FROM THE PLATINUM LIFTS TEAM



Visit us at our new lift showroom for a mince pie and a cup of tea!



0117 261 0123 | www.platinum-lifts.co.uk | info@platinum-lifts.co.uk
65 Henleaze Road, Henleaze, Bristol, BS9 4JT



HEN & BOAR
EST. 2022
BUTCHERS

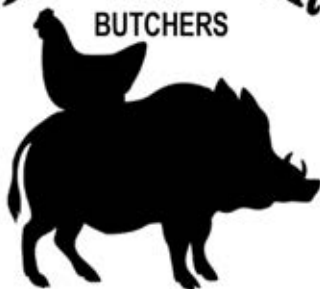

NOW TAKING ORDERS FOR CHRISTMAS

0117 462 1656

✉ MAIL@HENANDBOAR.COM

**COPAS FREE RANGE & ORGANIC
NORFOLK BRONZE TURKEYS
CAPON CHICKENS
GEESE
DUCKS**

**HENLEAZE CHRISTMAS FESTIVAL 2025
WEDNESDAY 3RD DECEMBER 4-8 PM**



★★★★★
READ REVIEWS ON

Google

@HENANDBOARHENLEAZE

KINDRED

CLINIC



I'm Dr Hannah

I have been a doctor in Bristol for over 18 years and founded KinDRed Clinic as a trusted destination for doctor-led skin, aesthetics, and wellness. At KinDRed, we believe you deserve nothing less than the best. That's why we invest in the latest, most advanced technology—and ensure every injectable treatment is carried out exclusively by highly experienced doctors.

Dr Hannah



Treatments

- Hydrafacial/Facials
- Massage including lymphatic drainage
- Emsella Pelvic Floor Chair - for continence issues
- Doctor- delivered anti-wrinkle treatments
- SkinPen microneedling
- Morpheus8
- Forma skin tightening
- Lumecca - for redness, thread veins and brown spots
- Cryopen (benign skin lesion removal)
- Laser hair removal
- Exosomes
- Polynucleotides and skin boosters



49 North View, Westbury Park
hello@kindredskin.co.uk



  @kindredclinic
www.kindredclinic.co.uk

Children`s Corner

The ever popular children`s rides will be in their usual spot in Cardigan Road providing a chance for young festival goers to let off steam and have some fun.

Father Christmas can be found there too sitting in his Grotto awaiting his young visitors queuing up excitedly awaiting their chance for a chat. And, who knows, perhaps they`ll get a little treat from the man in red.

Adding to the fun will be pick and mix and doughnut stalls which can be expected to do good business.



To avoid the inevitable crowds in Henleaze Road we suggest using the colourfully lit alleyway between Dublin Crescent and Cardigan Road to move between the two areas.

The Carpet Shop

- Free measuring service
- Fitting included in the carpet price
- Wide selection of styles and colours
- Fitters with over 20 years experience
- Professional, friendly and prompt service
- **Now supplying & fitting made to measure blinds**



Visit our showroom:
45 North View
Westbury Park
BS6 7PY



www.thecarpetshopbristol.co.uk

For free advice please call: 0117 973 4912

GYMBOREE

*Award winning classes from
newborn to 5 years*



*Book a
FREE
trial!*

**SENSORY BABY PLAY
PLAY & LEARN
MUSIC
OPEN GYM
SPECIAL EVENTS
BIRTHDAY PARTIES**

Find Out More Here



Gymboree Play & Music Bristol

The Annexe at 38 Eastfield, Westbury-On-Trym, Bristol, BS94BE
07453901951 • bristol@gymbo.co.uk • gymbo.co.uk/locations/bristol



Care starts at home

At Home Instead Bristol North, we offer all the care you or a loved one need to remain living safely and independently at home. Whether you are looking for support for one hour a day or full-time live-in care, we are here to help.

We understand the concerns that come with setting up care and how difficult it can be to encourage a loved one to accept help at home.

All the support we provide is built on consistent, relationship-based care, where clients and Care Professionals are matched to suit individual needs and given time for a trusted bond to develop.



Our hourly support includes:

- Companionship
- Home Help
- Personal Care
- Dementia Care
- Special Care
- Medication Support

If you are looking for live-in support...



Claire Kemp
and Sarah Parsons
Home Instead
Live-in Care Managers

Claire and Sarah, our Live-in Care Managers, have over 25 years of experience between them. Together, they will support and guide you through the process of setting up live-in care.

They will be with you every step of the way, and that support doesn't end once a package is set up. They are always on hand to help with any questions or concerns you may have, to make sure that your needs, or those of a loved one are fully met.

What's next?

If you would like to talk to us about hourly or live-in care, please do get in touch or pop into the office. You can call us on 01174350063 or visit our website www.homeinstead.co.uk/bristolnorth

33 Southmead Road, Westbury-on-Trym, BS105DW & 77B North Street, Downend, BS165SE



Edgie's Cafe

12a North View
BS67QB



Open 7 days a week
Mon-Fri 0800-1700
Sat 0900-1700
Sun 0900-1500



*Now taking orders for Christmas
Pop into the cafe to order!*

St Peter's Church (on The Drive BS9 4LD)

invites you to:

Wednesday 3rd December: Henleaze Christmas Fair:
3.30 – 6.30pm Children's Christmas Craft Activities
& Refreshments

Sunday 14th December
4.00pm Christingle Service

Sunday 21st December
6.30pm Carol Service followed by Mince Pies and Mulled Wine

Wednesday 24th December: Christmas Eve
2.30pm Crib Service: children encouraged to come in Nativity costume
4.00pm Crib Service: children encouraged to come in Nativity costume

Thursday 25th December: Christmas Day
8.00am Holy Communion
10.00am Christmas Celebration Communion

For details of all our activities and for information on hiring our Hall or Church visit
www.stpetershenleaze.org



MERRY CHRISTMAS *Henleaze!*

JOIN US FOR FREE MINCE PIES AND MULLED WINE!

HENLEAZE CHRISTMAS SPECIAL OFFER:

50% off

Chiropractic Initial Consultation!

~~£60~~ **£30**

Call us on:

0117 902 0039

and quote

Henleaze2025 to book

Helping with:

- Sciatica
- Neck pain
- Low Back Pain
- Headaches
- Pregnancy Related Pain
- Joint Pain
- Sports Injury

Chiropractic | Rehabilitation | Sports Therapy | Massage | Yoga | Pilates
www.orkuhealth.co.uk

Seasons greetings from AMD Solicitors



Lawyers for your family and business

www.amdsolicitors.com

(T): 0117 962 1205

westbury inks

PRINTING & PRINT SUPPLIES

INKS • TONERS • PRINTING • COPYING

25% OFF FULL SETS OF COMPATIBLE
INKS WITH THIS FLYER*

*EXPIRES JANUARY 31ST 2026



A BIG THANK YOU TO
ALL OUR CUSTOMERS

*Merry
Christmas*

& HAPPY NEW YEAR



0117329 2788 • info@westburyinks.co.uk • www.westburyinks.co.uk

Food Fest

Enjoy the festival with a glass of something nice and a tasty treat. There will be plenty to choose from among the local cafes and businesses.

There will be hot mulled wine to enjoy, plus hot chocolate and filled baguettes. Expect to find a nice line in burgers among the other tasty treats. And it wouldn't be the festive season without a hot roasted chestnuts stall.

What better way to enjoy the festival than stopping for a quick bite or a warming drink as you walk around. There will be plenty on offer to tickle the taste buds and enhance your festival experience.

An extension of the walkway with a barrier along part of Henleaze Road, where some shops will be serving outside, eases the flow of festival goers.



Come and share in our Christmas events at Trinity-Henleaze United Reformed Church

Sunday 14 December 7-8 pm. Traditional candlelit service of readings and favourite carols.

Christmas Eve 4-5 pm. Celebration Worship for all ages getting into the Spirit of Christmas.

Christmas Eve 11.30 pm-12.30 am. Midnight Worship to share bread and wine.

Christmas Day 10.30-11.30 am. Christmas Morning Celebration worship for all ages.





Discover a new way to dine at Loafer in Henleaze, where every plate is made to be shared.

From tender pork ribs with chilli honey to seared duck in a peach glaze, our menu brings global flavours to your table.

Small plates, wine and local beer available every Thursday, Friday and Saturday evening from 17:00 – 21:00

Loafer

105 Henleaze Road, BS9 4JP | hello@loafercoffee.co.uk | www.loafercoffee.co.uk | 0117 452 2428



Professional Swedish Barber

Monday - Saturday

9.00m - 6.00 pm

178 Henleaze Road



bristol carpets

*Merry
Christmas!*



102-104 Henleaze Road, Henleaze, Bristol BS94JZ

tel no: 0117 9517717

email: bristolcarpetman@gmail.com

website: bristolcarpets.co

Over the Years





WITH
**15%
OFF***
HEARING
AIDS

BOOK YOUR
FREE
HEARING
HEALTH CHECK

*Offer is available for Widex 440
and 330 hearing aids only.
Visit Bayfieldsopticians.com
for full T&Cs.

MERRY CHRISTMAS

from

BAYFIELDS

— OPTICIANS & AUDIOLOGISTS —

www.bayfieldsopticians.com
45 Henleaze Road, Bristol, BS9 4JU

The perfect place to find all your Christmas gifts - for everyone!

CHRISTMAS SHOPPING MADE EASY

EST



2011

KONDI

GIFT & HOME

Kondi, 103 Henleaze Road, Bristol BS9 4JP

t: 0117 962 5464 e: gifts@kondis.co.uk

Mon - Fri 9.30am - 5.15pm
Saturday 9.30am - 5.00pm

Lifestyle · Jewellery · Toiletries · Cards · Children's



Move Home **Without The Stress**

☎ 0117 28 700 82

🌐 painlessremovals.com



La Scala

The Italian Hub of Henleaze

Wine Tastings

CELEBRATING TWO YEARS OF
REGIONAL & THEMED TASTINGS

**November: Christmas Selection 6th, Wine & Dine Umbria 8th, Christmas Selection 14th,
Christmas Selection 15th, Christmas Selection 20th**

**December: Christmas Selection 4th, Christmas Selection 5th, Christmas Selection 11th,
Wine & Dine Umbria 13th**

5 WINES ● APERITIVO BOARD ● SOMMELIER

PRIVATE
TASTINGS

Full Venue - From 12ppl - Enquire Online

www.lascaladeli.com

 @lascaladeli

Useful Information

Travelling to the Festival

Please help us to reduce the congestion to a minimum by walking to the Festival or arriving by bike. Henleaze Road gets very congested due to the amount of traffic and pedestrians using it. There will also be very limited parking in the side roads due to road closures. Wherever you park, please be considerate to the residents.

Lost Children/First Aid

There will be a Lost Children and First Aid point in Cardigan Road beside Santa`s Grotto.

Lost Property

Please give any lost or found property to anyone with a Henleaze Christmas Festival Hi-Viz tabard.

Disabled Parking

We have again included a special disabled parking area to add further facilities on the night for Blue Badge holders. We are grateful to St Peter`s Church for making their car park in The Drive available where up to eight spaces will be allocated. A marshal will be on duty to offer assistance.

Rubbish

Bristol City Council insist that we have recycling bins as part of our licence. Please use them, they will be situated in prominent places e.g. by food outlets. If they are not used it could jeopardise our licence for future years. Please remember that the Festival team of volunteers cannot go home until all the rubbish is cleared. So your co-operation would be greatly appreciated.

Security

We have employed Security staff who will be present throughout the festival period and will be wearing Hi-Viz jackets. Should you have any security concerns e.g. suspicious persons or a package, please notify one of the Security staff immediately. Alternatively seek advice from any of the festival organisers - wearing the Hi-Viz Festival tabard. Remember to keep well clear of the threat.

Bus Stop Henleaze Road

As in previous years we will be applying to close the bus stop near Parsons Bakery and have a temporary bus stop outside Costa for the duration of the Festival.



*A Happy Christmas
to all
Festival goers*



Merry Christmas & Happy New Year!



The
Bristol
Agent

You'll be pleased to know that your local CJ Hole offices, Henleaze & Westbury-on-Trym, are delighted to once again be the exclusive sponsor of the Henleaze Christmas Festival.

Jointly selling homes across BS6, BS9 & BS10

HENLEAZE

108 Henleaze Road
Henleaze, BS9 4JZ

Sales & Lettings:

0117 962 9221

henleaze@cjhole.co.uk

WESTBURY-ON-TRYM

25 Canford Lane
Westbury, BS9 3DQ

Sales & Lettings:

0117 950 0118

westbury@cjhole.co.uk



SCAN THE QR



TO FOLLOW US

People, Places & Property – Bristol Built

Follow us on Instagram for the latest properties, community news, and exciting competitions.

Stay in the know!

