

電池與變壓器資訊

使用電源

請確定要連接的電源插座位在方便取得的位置，並盡可能靠近設備操作員。需要中斷設備電源時，請確定拔除電源插座連線。

中斷電源

在連接及中斷電源供應器的電源時，請注意下列事項：

- 請先安裝電源供應器，然後再連接至 AC 電源插座。
- 請先拔除連線，然後再將電源供應器從顯示器移除。
- 如果系統有多個電源，請將所有電源線從電源拔出，以中斷系統電源。

電力使用

- 請勿將本顯示器專用的電源轉接器給其他裝置使用。
- 拔掉電源線時，需握住插頭部位，請勿直接拉扯電源線。
- 本產品僅可使用電源線標籤所規定的電壓。如果您不確定該使用何種電源，請向經銷商或當地電力公司尋求協助。
- 請勿在電源線上面放置任何重物。電源線的走線或配置要特別小心，避免放在會被物品或腳絆到的地方。
- 使用延長線時，請注意其電流負荷量。插在同一延長線的電器設備使用電量不可超過延長線的電流負荷量。同時，同一插座的耗電量也不可超過保險絲的負荷量。
- 請勿將電源插座、延長線或插座與太多裝置連接，以免負荷量過重。整體的系統負載量不得超過分支電路功率的 80%。如果使用的是延長線，則其負載量不應超過延長線輸入功率的 80%。
- 如本產品隨附的 AC 變壓器配有二線式接地插頭，此插頭僅適合用於與接地插座連接。請在插入 AC 變壓器插頭前，確認該插座已接地。請勿將插頭插入一個非接地式的插座。如需詳細資訊，請與電氣技師洽詢。

警告
為防止產生高溫及損壞裝置，請務必將 AC 變壓器完全插入顯示器的 DC 輸入插孔，並將電源線完全插入電源插座。

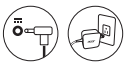

警告
插頭的接地腳是一個安全防護功能。在使用電源插座時如果接地不完全，可能會發生電擊並/或造成身體傷害。

注意
接地腳同時提供了良好的保護，避免鄰近電子裝置對產品性能產生干擾及製造噪音。

- 系統可使用各種不同電壓進行供電 (100 至 120 或 220 至 240V，或 100 至 -240 VAC)。系統隨附電源線符合購買所在國家/地區的使用需求。在其他國家/地區使用電源線時，必須符合當地的使用需求。
- 如需關於電源線需求的詳細資訊，請洽詢授權經銷商或服務供應商。

電池安全使用指南

警告
使用充電車或狹小空間同步充電或操作多個裝置時，必須有良好的通風，且溫度必須保持介於 0°C (32°F) 至 35°C (95°F) 之間，而且必須在到達 100% 電量時停止電池充電。

持續充電可能會導致電池 / 裝置變形或損壞。

電池充電的安全守則

下列行為會對電池的使用壽命產生不良影響：

- 經常在電量已滿時對電池 / 裝置進行充電。
- 在溫度高於 35°C (95°F) 或低於 0°C (32°F) 時對電池 / 裝置進行充電。
- 為了避免損壞，請遵照下列守則：
 - 在電量到達 100% 時立即停止對電池進行充電；若長期或經常對已充滿的電池再繼續充電一段時間，可能會導致電池變形或損壞。建議您在電池電量低於 70% 時對裝置進行充電。
 - 請勿在溫度高於 35°C (95°F) 或低於 0°C (32°F) 時對電池進行充電。在異常高溫或異常低溫的情況下充電可能會導致電池變形或損壞。
 - 充電連接埠必須保持乾淨且無碎屑，而且僅能搭配充電設備使用。使用非產品的電池或充電設備可能會導致產品損壞，而且保固將會失效。
- 如果您預計要長時間存放裝置：
 1. 請拔下 AC 電源。
 2. 將開關按鈕長按 >10 秒關機，並將產品存放在室溫 (0°C - 35°C)、乾燥 (溼度：45% - 80%) 且通風良好的區域。避免強烈日照、高溫和濕度高的環境。請勿讓裝置的電池長時間完全放電；這可能會導致電池變形或損壞。建議檢查電池，並每隔 6 個月將電池充電到藍燈閃爍的電量。
- 僅在乾淨、通風良好的區或對電池進行充電。

警告
未正確處理電池可能會爆炸。請勿拆解電池或將電池丟入火中。請勿讓外部接點短路、壓住、穿刺或以其他方式損壞電池。請將電池放在孩童無法拿取的地方。請根據當地法規棄置用過的電池。

更換電池的安全守則

- 更換或處理不當可能會損壞電池、導致過熱、造成人身傷害，及導致火災或爆炸的風險。
- 含有內建電池的裝置：內建電池必須由授權服務中心進行更換。請勿嘗試自行更換或拆卸電池。
- 含有可拆式電池的裝置：僅能使用通過認證的零件更換電池。除了通過認證的零件以外，請勿使用任何其他零件更換電池。
- 本顯示器使用的是鋰電池。請勿在潮濕或腐蝕性的環境中使用此電池。請勿將產品放置、存放或靠近熱源、置於高溫位置、放在強烈日照下、放在微波爐或加壓容器中，並且請勿暴露於 50°C (122°F) 以上的溫度中。
- 若未遵守上述規定，可能會導致電池漏出酸液、發熱、爆炸或燃燒，而造成受傷及(或)損壞。請勿穿刺、開啟或拆解電池。若您有電池漏液時接觸到漏出的液體，請以清水徹底清洗，並立即就醫，基於安全理由，且為了延長電池的使用壽命，在 0°C (32°F) 以下或 35°C (95°F) 以上的溫度中將無法進行充電。
- 新電池要經過兩到三次完整的放電過程後，才能發揮完整的效能。電池可充放電數百次，但是電力會逐漸下降。若開機操作時間異常短於正常時間，請洽詢授權經銷商購買新的電池。
- 請僅按照使用目的使用電池，勿使用損壞的充電器或電池。勿使電池發生短路。以錢幣、金屬片或筆之類的金屬物品直接連接電池的正極 (+) 和負極 (-) 端時時，可能會不小心引發短路。(電極接點看起來就像電池上的金屬條。) 尤其當您將備用電池放置於口袋或皮包內時，就可能發生這種情形。電池正負極發生短路可能會損壞電池或相連的物體。

如果您將電池放置在過熱或熱冷的環境中 (例如夏天或冬天的密閉車廂內)，可能會導致電池容量和使用壽命縮短。請務必將電池存放在溫度介於 15°C 至 25°C (59°F 至 77°F) 的環境中。置入高溫或低溫電池，可能會暫時無法使用，即使在充滿電的情況下亦同。在極度過低的溫度下更會使電池效能受到限制。

勿將電池丟入火中，以免引起爆炸。損壞的電池也可能會爆炸。請根據當地法規棄置電池，若有可能請回收電池，勿以家庭廢棄物進行棄置。

無線裝置可能會受到電池干擾，並因而影響效能。

內建電池

- 請勿嘗試更換內建充電電池，電池更換必須交由修復場備使用。
- 請遵照產品說明文件隨附的指示對電池進行充電。

若要安裝或更換遙控器電池：

- 按住外蓋後滑動即可開啟。
- 依照電池盒內的 (+) 和 (-) 指示排列電池。
- 裝回外蓋。

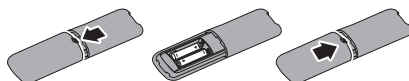

註

使用電池的方式不正確會導致電池漏液或爆裂。請確定依循這些指示操作：

- 將「AAA」電池上的 (+) 和 (-) 標誌與電池盒的 (+) 和 (-) 標誌相對。
- 請勿混用不同的電池類型。
- 請勿混用新舊電池。這會造成使用壽命縮短或電池漏液。
- 立即取出沒電的電池，以免在電池盒中的電池漏液。切勿接觸外洩的電池酸性物質，因為這會傷害您的皮膚。
- 如果打算長時間不使用遙控器，請取出電池。

設備名稱：液晶顯示器 Equipment name	禁用物質及其化學符號 Restricted substances and its chemical symbols					
	鉛 Lead (Pb)	汞 Mercury (Hg)	鎘 Cadmium (Cd)	六價鉻 Hexavalent chromium (Cr+6)	多溴聯苯 Polybrominated biphenyls (PBB)	多溴二苯醚 Polybrominated diphenyl ethers (PBDE)
顯示板	-	○	○	○	○	○
顯示器	○	○	○	○	○	○
立桿	○	○	○	○	○	○
底座	○	○	○	○	○	○
電源線	○	○	○	○	○	○
配件 (遙控器、說明書)	○	○	○	○	○	○

備註 1: "超出 0.1 wt %" 及 "超過 0.01 wt %" 係指禁用物質之百分比含量超出百分比含量基準值。
Note 1: "Exceeding 0.1 wt %" and "exceeding 0.01 wt %" indicate that the percentage content of the restricted substance exceeds the reference percentage value of presence condition.
備註 2: "○" 係指該項禁用物質之百分比含量未超出百分比含量基準值。
Note 2: "○" indicates that the percentage content of the restricted substance does not exceed the percentage of reference value of presence.
備註 3: "-" 係指該項禁用物質為排除項目。
Note 3: The "-" indicates that the restricted substance corresponds to the exemption.

重要安全指示

請謹慎閱讀下方指示

1. 欲清潔顯示器螢幕：
 - 將顯示器關閉並拔除電源線。
 - 將非溶劑清潔液噴於軟布並輕輕擦拭螢幕。
2. 請勿將顯示器置於窗戶附近。使顯示器暴露於雨水、潮濕或日光會嚴重損害顯示器。
3. 請勿使顯示器受壓。過大的壓力可能對顯示器造成永久損傷。
4. 請勿移除機殼或嘗試自行維修裝置，應由專業合格的維修人員執行維修工作。
5. 請將顯示器存放於 -20° 至 60°C (-4° 至 140°F) 溫度的房間。將顯示器存放於此範圍外之處可能導致永久損傷。
6. 若任何下列情況發生，請立即拔除您的顯示器並聯絡專業合格的維修人員。
 - 顯示器至電腦的訊號線磨損或毀壞。
 - 液體濺到顯示器上或顯示器暴露於雨水。
 - 顯示器或機殼損壞。

注意(配備電池的適用型號)

- 更換錯誤類型的電池可能會破壞保護裝置。
- 將電池丟入火或高溫烤箱，或以機械方式壓扁或切割電池可能會導致爆炸。
- 將電池放置於極高溫的環境中可能會導致爆炸，或易燃液體或氣體洩漏。
- 電池承受極低氣壓可能會導致爆炸，或易燃液體或氣體洩漏。
- 若更換錯誤類型的電池可能會導致火災或爆炸風險。

穩定性危險

本產品可能會掉落，並導致嚴重的人員受傷或死亡。為避免受傷，本產品必須依安裝說明穩固地安裝於地面/牆壁上。

- 產品組可能會掉落，並導致嚴重的人員受傷或死亡。採取以下簡易預防措施，即可避免許多受傷情形(尤其是兒童)：
 - 請務必使用產品組製造商建議的機櫃或支架或安裝方法。
 - 請務必使用可安全支撐本產品的傢俱。
 - 請務必確保產品未突出支撐傢俱的邊緣。
 - 請務必教育兒童攀爬傢俱以取得本產品或其遙控器的相關危險情況。
 - 請務必妥善繞置連接本產品的電線及纜線，以免遭到拉扯或使人絆倒。
 - 切勿將產品放置於不平整處。
 - 在未將傢俱及產品固定於適當支撐物的情況下，切勿將產品放置於較高的傢俱上(例如，櫥櫃或書櫃)。
 - 切勿將產品放置於布或可能位於產品及支撐傢俱間的其他物質上。
 - 切勿在產品或放置產品的傢俱上擺放可能誘使兒童攀爬的物品，如玩具及遙控器。
- 若要使用和重新放置現有產品，同樣適用上述考量。

註

本顯示器可使用 100mm x 100mm VESA 相容安裝介面。VESA 固定螺絲 (M4 或 M6)。如需壁掛安裝，務必聯絡製造商。(具備壁掛安裝功能的型號)

Battery and adapter information

Accessing the power

Be sure that the power outlet you plug into is easily accessible and located as close to the equipment operator as possible. When you need to disconnect power to the equipment, be sure to unplug from the electrical outlet.

Disconnecting the power source

Observe the following guidelines when connecting and disconnecting power to the power supply unit:
Install the power supply unit before connecting to the AC power outlet.
Unplug before removing the power supply unit from the monitor.
If the system has multiple sources of power, disconnect power from the system by unplugging all power cords from the power supplies.

Using electrical power

- Do not connect the adapter to any other device.
- When unplugging the power cord, do not pull on the cord itself but pull on the plug.
- This product should be operated from the type of power indicated on the marking label. If you are not sure of the type of power available, consult your dealer or local power company.
- Do not allow anything to rest on the power cord. Do not locate this product where people will walk on the cord.
- If an extension cord is used with this product, make sure that the total ampere rating of the equipment plugged into the extension cord does not exceed the extension cord ampere rating. Also, make sure that the total rating of all products plugged into the wall outlet does not exceed the fuse rating.
- Do not overload a power outlet, strip or receptacle by plugging in too many devices. The overall system load must not exceed 80% of the branch circuit rating. If power strips are used, the load should not exceed 80% of the power strip's input rating.
- If this product's AC adapter is equipped with a two-wire grounded plug. The plug only fits in a grounded power outlet. Make sure the power outlet is properly grounded before inserting the AC adapter plug. Do not insert the plug into a non-grounded power outlet. Contact your electrician for details.

Warning

To prevent high temperature and device damage, please connect the AC adaptor into DC-in jack on the monitor fully and plug the power cord into electric outlet completely at all times.

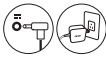

Warning

The grounding pin is a safety feature. Using a power outlet that is not properly grounded may result in electric shock and/or injury.

Note

The grounding pin also provides good protection from unexpected noise produced by other nearby electrical devices that may interfere with the performance of this product.

- The system can be powered using a wide range of voltages; 100 to 120 or 220 to 240 V or 100-240 V AC. The power cord included with the system meets the requirements for use in the country/region where the system was purchased. Power cords for use in other countries/regions must meet the requirements for that country/region. For more information on power cord requirements, contact an authorized reseller or service provider.

Guidelines for safe battery usage

Warning

When using a charging cart or a small space to simultaneously charge or operate multiple devices, the area must be well-ventilated and the temperature kept between 0 °C (32 °F) to 35 °C (95 °F) and battery charging must be stopped when 100% capacity is reached. Continuous charging can cause deformation or damage to the battery/device.

Precautions when charging batteries

The useful lifespan of a battery is adversely affected by the following behavior:

- Constantly charging the battery/device when already at full capacity.
- Charging the battery/device at temperatures above 35 °C (95 °F) or below 0 °C (32 °F).
- To prevent damage, follow these precautions:
 - Stop charging the battery once it reaches 100% capacity; regularly or frequently charging a fully charged battery for an extended period of time may cause battery deformation or damage. We recommend that you recharge the device when the battery level drops below 70% capacity.
 - Do not charge battery in temperatures above 35 °C (95 °F) or below 0 °C (32 °F). Charging in abnormally high or abnormally low temperatures can cause battery deformation or damage.
- The charging port must be clean and free from debris and should only be used with the monitor charging equipment. Use of a non-monitor battery or charging equipment can cause damage to the product and will void the warranty.
- If you expect to store the device for an extended period of time:
 1. Please unplug the AC power source.
 2. Press and hold the switch button for >10 seconds to turn off the product, and store the product in a room temperature (0°C – 35°C), dry (humidity: 45% – 80%) and well-ventilated area. Avoid environments with strong sunlight, high temperatures and high humidity. Do not allow the device's battery to fully discharge for an extended period of time; this may cause the battery to become deformed or damaged. It is recommended to check the battery and charge it to a level where the blue light stays on every 6 months.
- ONLY CHARGE THE BATTERY IN A CLEAN, WELL VENTILATED AREA.

Warning

Batteries may explode if not handled properly. Do not disassemble or dispose of batteries in fire. Do not short external contacts, crush, puncture or otherwise tamper with batteries. Keep batteries away from children. Follow local regulations when disposing of used batteries.

Precautions when replacing the battery

- Improper replacement or mishandling could damage the battery, cause overheating, result in injury, and risk fire or explosion.
- Device with built-in battery: A built-in battery must be replaced by an authorized service center. Do not attempt to replace or remove the battery by yourself.
- Device with removable battery: The battery should only be replaced using approved parts. Do not replace the battery with any parts other than approved ones. This monitor uses a Lithium-based battery. Do not use it in a humid, wet or corrosive environment. Do not put, store or leave your product in or near a heat source, in a high temperature location, in strong direct sunlight, in a microwave oven or in a pressurized container, and do not expose it to temperatures over 50 °C (122 °F). Failure to follow these guidelines may cause the battery to leak acid, become hot, explode or ignite and cause injury and/or damage. Do not pierce, open or disassemble the battery. If the battery leaks and you come into contact with the leaked fluids, rinse thoroughly with water and seek medical attention immediately. For safety reasons, and to prolong the lifetime of the battery, charging will not occur at temperatures below 0 °C (32 °F) or above 35 °C (95 °F). The full performance of a new battery is achieved only after two or three complete charge and discharge cycles. The battery can be charged and discharged hundreds of times, but it will eventually wear out. When the operation time becomes noticeably shorter than normal, check an authorized reseller to purchase a new battery. Use the battery only for its intended purpose. Never use any charger or battery that is damaged. Do not short-circuit the battery. Accidental short-circuiting can occur when a metallic object such as a coin, clip or pen causes direct connection of the positive (+) and negative (-) terminals of the battery. (These look like metal strips on the battery.) This might happen, for example, when you carry a spare battery in your pocket or purse. Short-circuiting the terminals may damage the battery or the connecting object.

The capacity and lifetime of the battery will be reduced if the battery is left in hot or cold places, such as in a closed car in summer or winter. Always try to keep the battery between 15 °C and 25 °C (59 °F and 77 °F). A device with a hot or cold battery may not work temporarily, even when the battery is fully charged. Battery performance is especially limited in temperatures well below freezing.
Do not dispose of batteries in a fire as they may explode. Batteries may also explode if damaged. Dispose of batteries according to local regulations. Please recycle when possible. Do not dispose as household waste. Wireless devices may be susceptible to interference from the battery, which could affect performance.

Internal battery

- Do not attempt to replace a built-in rechargeable battery, battery replacement must be done by an authorized repair facility.
- Recharge the battery by following the instruction included in the product documentation.

To install or replace Remote Control batteries

- Press and then slide the cover to open it.
- Align the batteries according to the (+) and (-) indications inside the battery compartment.
- Replace the cover.

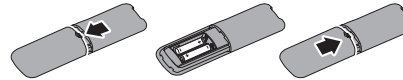

Note

The incorrect use of batteries can result in leaks or bursting. Be sure to follow these instructions:

- Place AAA batteries matching the (+) and (-) signs on each battery to the (+) and (-) signs of the battery compartment.
- Do not mix battery types.
- Do not combine new batteries with used ones. It causes shorter life or leakage of batteries.
- Remove the dead batteries immediately to prevent them from liquid leaking in the battery compartment. Don't touch exposed battery acid, as it can damage your skin.
- If you do not intend to use the remote control for a long period, remove the batteries.

Important safety instructions

Please read the following instructions carefully.

1. To clean the LCD monitor screen:
 - Turn off the LCD monitor and unplug the power cord.
 - Spray a non-solvent cleaning solution onto a rag and clean the screen gently.
2. Do not place the LCD monitor near a window. Exposing the monitor to rain, moisture or sunlight can severely damage it.
3. Do not apply pressure to the LCD screen. Excessive pressure may cause permanent damage to the display.
4. Do not remove the cover or attempt to service this unit yourself. An authorized technician should perform servicing of any nature.
5. Store the LCD monitor in a room with a temperature of -20° to 60° C (-4° to 140° F). Storing the LCD monitor outside this range may result in permanent damage.
6. Immediately unplug your monitor and call an authorized technician if any of the following circumstances occur:
 - Monitor-to-PC signal cable is frayed or damaged.
 - Liquid spills onto the LCD monitor or the monitor is exposed to rain.
 - The LCD monitor or case is damaged.

Caution(Applicable models with battery)

- Replacement of a battery with an incorrect type that can defeat a safeguard.
- Disposal of a battery into fire or a hot oven, or mechanically crushing or cutting of a battery, that can result in an explosion.
- Leaving a battery in an extremely high temperature surrounding environment that can result in an explosion or the leakage of flammable liquid or gas.
- A battery subjected to extremely low air pressure that may result in an explosion or the leakage of flammable liquid or gas.
- Risk of fire or explosion if the battery is replaced by an incorrect type.

Stability Hazard

The product may fall, causing serious personal injury or death. To prevent injury, this product must be securely attached to the floor/wall in accordance with the installation instructions. A product set may fall, causing serious personal injury or death. Many injuries, particularly to children, can be avoided by taking simple precautions such as:

- ALWAYS use cabinets or stands or installation methods recommended by the manufacturer of the product set.
- ALWAYS use furniture that can safely support the product.
- ALWAYS ensure the product is not overhanging the edge of the supporting furniture.
- ALWAYS educate children about the dangers of climbing on furniture to reach the product or its controls.
- ALWAYS route cords and cables connected to your product so they cannot be tripped over, pulled or grabbed.
- NEVER place a product in an unstable location.
- NEVER place the product on tall furniture (for example, cupboards or bookcases) without anchoring both the furniture and the product to a suitable support.
- NEVER place the product on cloth or other materials that may be located between the product and supporting furniture.
- NEVER place items that might tempt children to climb, such as toys and remote controls, on the top of the product or furniture on which the product is placed.
- If the existing product is going to be retained and relocated, the same considerations as above should be applied.

Note

This monitor accepts a 100mm x 100mm VESA-Compliant mounting interface. VESA Mounting Screw (M4 or M6). Always contact manufacturer for wall-mount installation. (For models with wall mount)