

专业提供:

各种用途的篷房, 包括: 活动 / 派对 / 展览 / 婚礼 / 仓库 / 工业

Professionally provided:

Tents for various purposes, including: events / parties / exhibitions / weddings / warehousing / industrial use.



■ Add: No.86, Foshan (Yunfu) Industrial Transfer Industrial Park, Yunan District, Yunfu City, Guangdong Province, China
中国广东省云浮市云安区佛山(云浮)产业转移工业园 86 号
Tel: +86 136 0231 1830 / 139 2913 3943
Web: www.protentierpergola.com
Email: info@protentierpergola.com

■ 由于印刷关系, 图片与产品实物存在一定色差, 一切以实物为准

CATALOG MANUAL

Protentier Pergola & Awning Co., Limited

Contents

 关于我们
ABOUT US

 产品介绍
Product Introduction

 篷房案例
Tent successful case

 篷房配套
Tent accessory

公司简介 Company profile P4-P5

人字形篷房 Event tent P6-P11

圆顶篷房 Dome tent P12

半圆顶篷房 Half dome tent P13

拱形篷房 Arched tent P14

弧顶篷房 Arcum tent P15

多边形篷房 Polygon tent P16

弯柱篷房 Curve tent P17

组合篷房 Mixed tent P18-P19

双层篷房 Double decker P20

中庭帐篷 Atrium tent P21

球形篷房 Geodesic dome tent P22-P23

吊顶篷 Gazebo tent P24

XL吊顶篷 XL Gazebo tent P25

张拉篷 Tension tent P26-P27

锥顶篷 Pagoda tent P28-P29

六边形锥顶篷 Hexagonal pagoda tent P30

立柱篷 Pole tent P31

F篷 Frame tent P32-P33

篷房案例 Tent successful case P34

篷房配套设施 Tent accessories P35

篷房管材 Tent pipe P36-P37

篷房布料 Tent fabric P38-P39

COMPANY PROFILE

公司简介

1997

CNC

100

今天的质量
Quality Anchored Today

明天的市场
Develop Without Delay

We are a leading company specializing in the design, manufacturing, sales, and service of awnings, carports, pergolas, and tents. Founded in 1997, we are committed to delivering high-quality, safe, and elegant outdoor sunshade solutions.

Our tent series products are renowned for their stability, safety, and aesthetic appeal. These fast-assembling, large-capacity structures are ideal for a wide range of applications, including exhibitions, conferences, sports venues, transportation promotions, and celebrations (such as beer festivals, food festivals, and music festivals).

To maintain production efficiency and superior product quality, we have invested in advanced machinery, including aluminum extrusion equipment, CNC aluminum cutting and drilling machines, robotic automatic welding systems, laser cutting machines, automatic fabric cutting machines, high-frequency hot-pressing machines, and automated spraying lines.

Through continuous innovation and dedicated efforts, our products have been successfully exported to over 100 countries, earning widespread recognition and appreciation from both domestic and international customers.

We will continue to uphold the principle of "Quality Anchored Today, Develop Without Delay" and welcome extensive collaborations with customers worldwide. Guided by a commitment to sincerity, trustworthiness, and mutual benefit, we look forward to partnering together to create a brighter future.

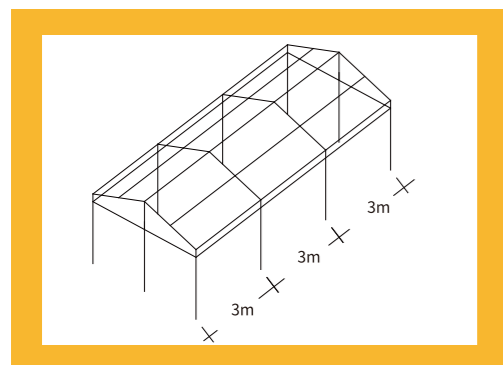

跨度 Span	间隔 Bay distance	边高 Eave height	总高 Total height	主要型材 Main profile
3m	3m	2.6m	3.3m	84x48x2.6mm
4m	3m	2.6m	3.4m	84x48x2.6mm
5m	3m	2.6m	3.6m	84x48x2.6mm
6m	3m	2.6m	3.8m	84x48x2.6mm
8m	3m	2.6m	4.2m	84x48x2.6mm
9m	3m	2.6m	4.5m	84x48x2.6mm
10m	3m	2.6m	4.7m	84x48x2.6mm

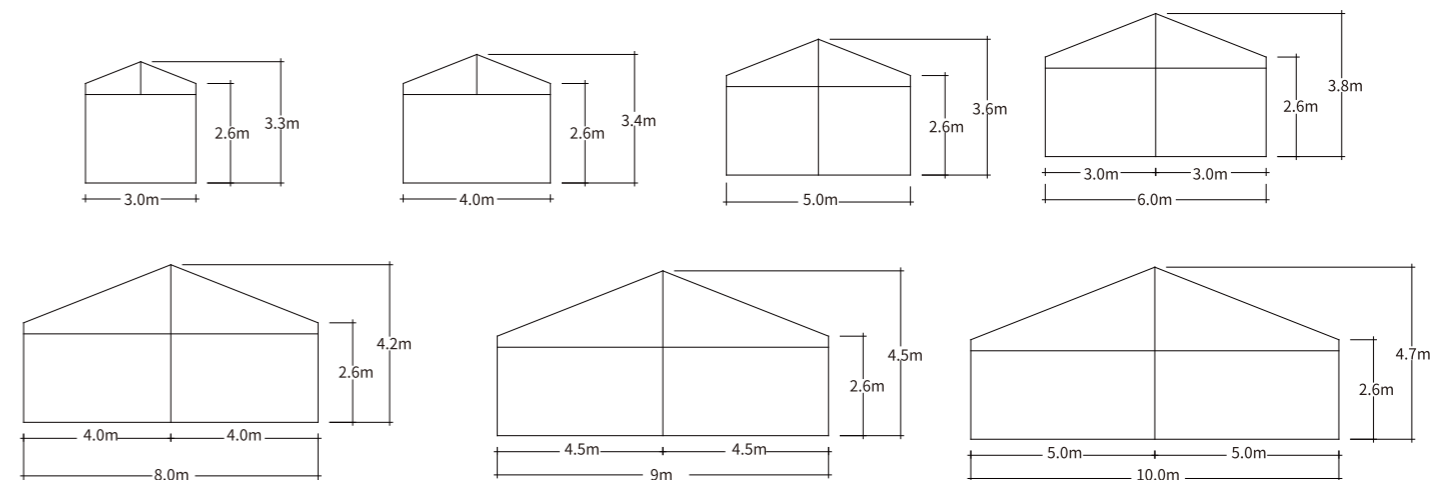

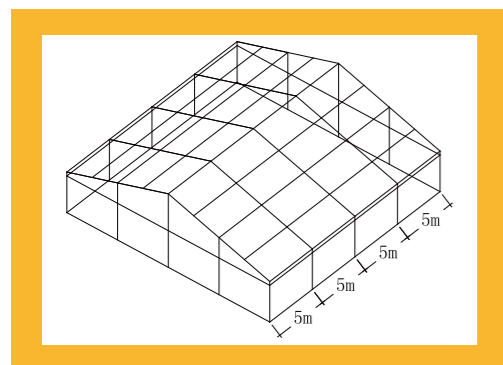

跨度 Span	间隔 Bay distance	边高 Eave height	总高 Total height	主要型材 Main profile
10m	5m	3m	4.9m	121x68x3.0mm
12m	5m	3m	5.2m	121x68x3.0mm
15m	5m	3m	5.7m	166x88x3.0mm
18m	5m	3m	6.2m	166x88x3.0mm
20m	5m	4m	7.2m	203x110x4.0mm
25m	5m	4m	8.0m	203x110x4.0mm

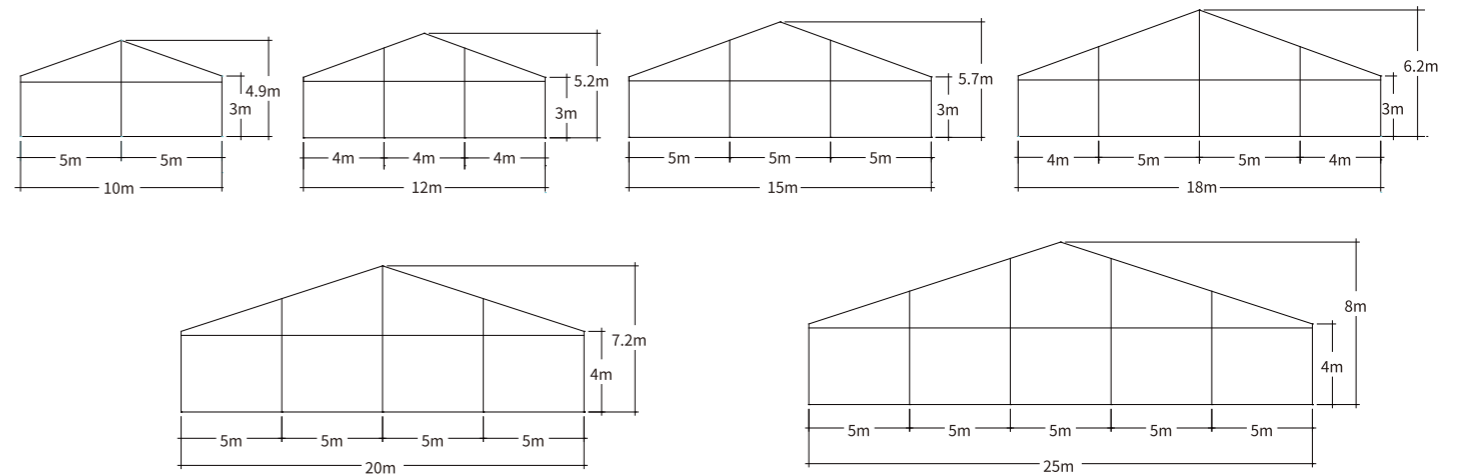

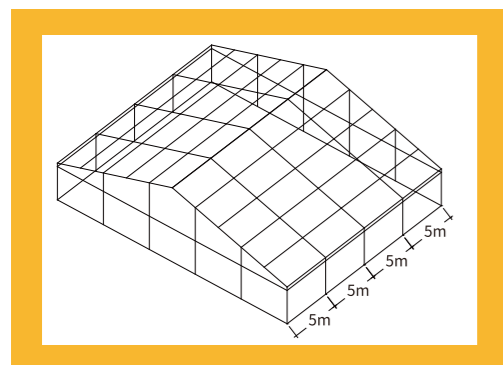

跨度 Span	间隔 Bay distance	边高 Eave height	总高 Total height	主要型材 Main profile
30m	5m	4m	8.8m	255x115x5.0mm
35m	5m	4m	9.7m	300x120x5.5mm
40m	5m	4m	11m	335x123x5.0mm

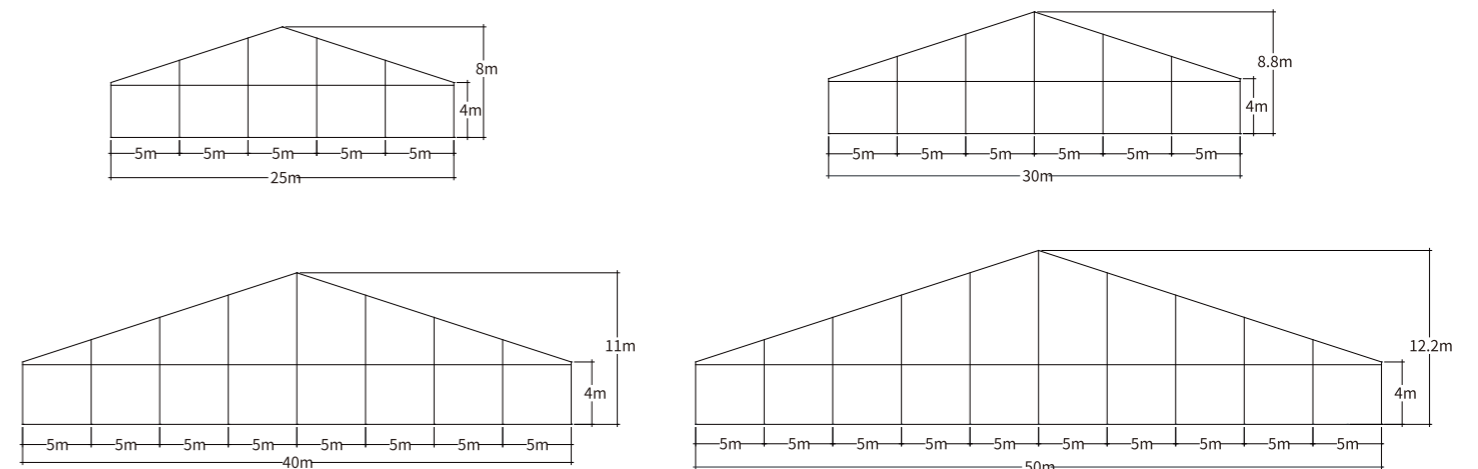

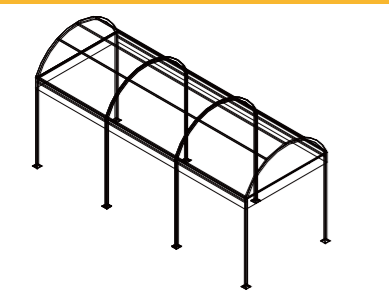
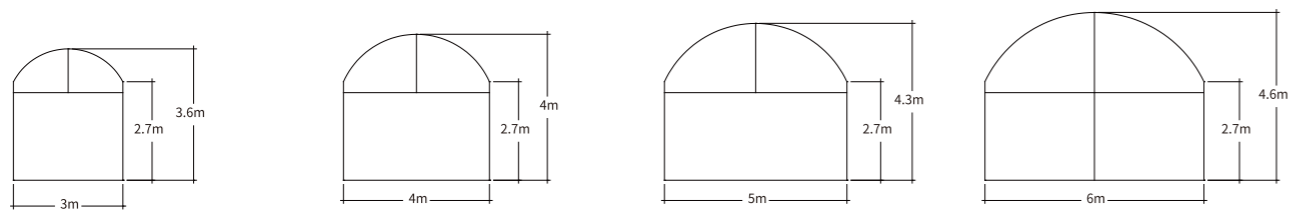

跨度 Span	间隔 Bay distance	边高 Eave height	主要型材 Main profile
3m	3m	2.7m	84x48x2.6mm
4m	3m	2.7m	84x48x2.6mm
6m	3m	2.7m	84x48x2.6mm
8m	3m	2.7m	84x48x2.6mm
10m	5m	2.7m	121x68x3.0mm
12m	5m	2.7m	121x68x3.0mm

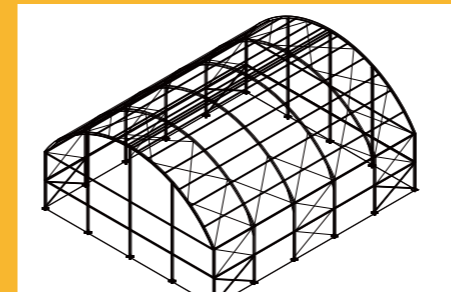
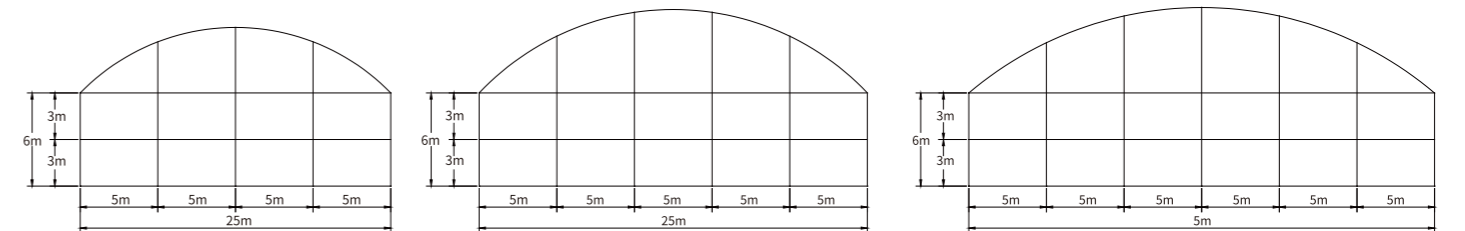

跨度 Span	间隔 Bay distance	边高 Eave height
15m	5m	6m
20m	5m	6m
25m	5m	6m
30m	5m	6m

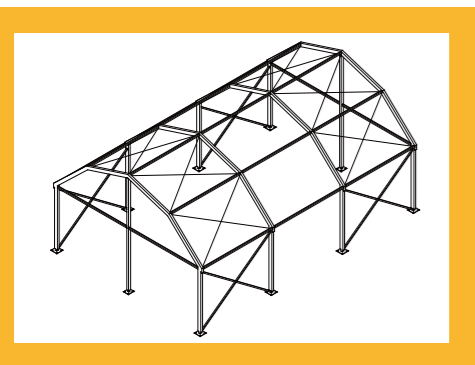
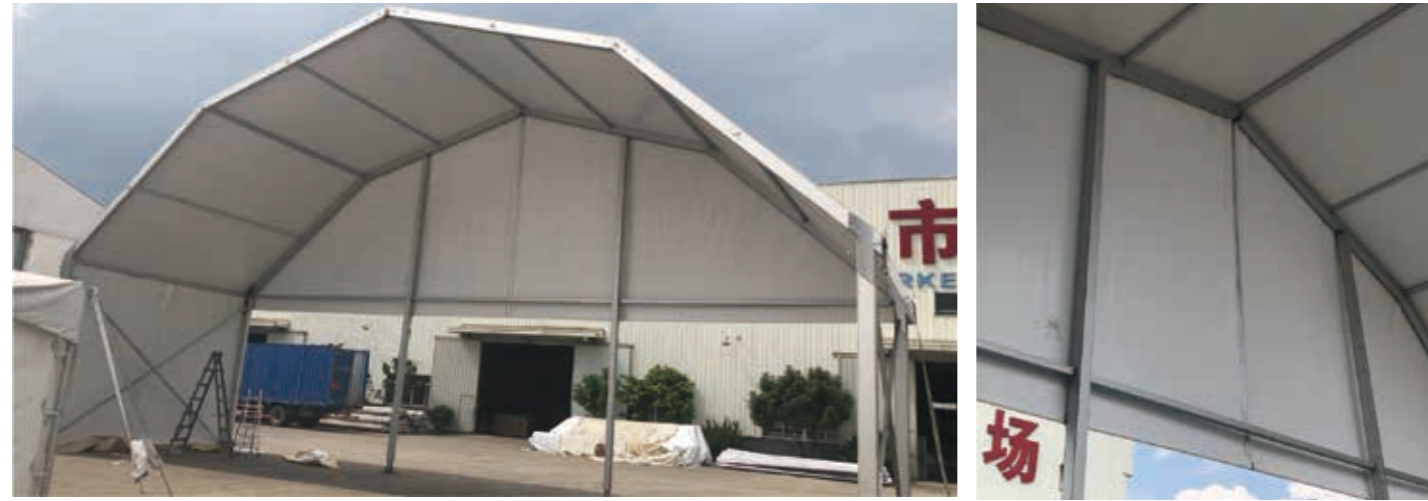

跨度 Span	间隔 Bay distance	边高 Eave height	总高 Total height
6m	3m	2.5m	3.7m
9m	3m	2.5m	4.1m
10m	5m	4.0m	5.8m
12m	5m	4.0m	6.0m
15m	5m	4.0m	6.5m
20m	5m	4.0m	7.2m
30m	5m	4.0m	8.8m

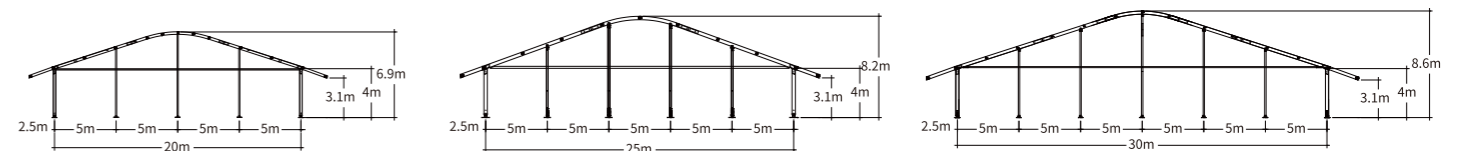
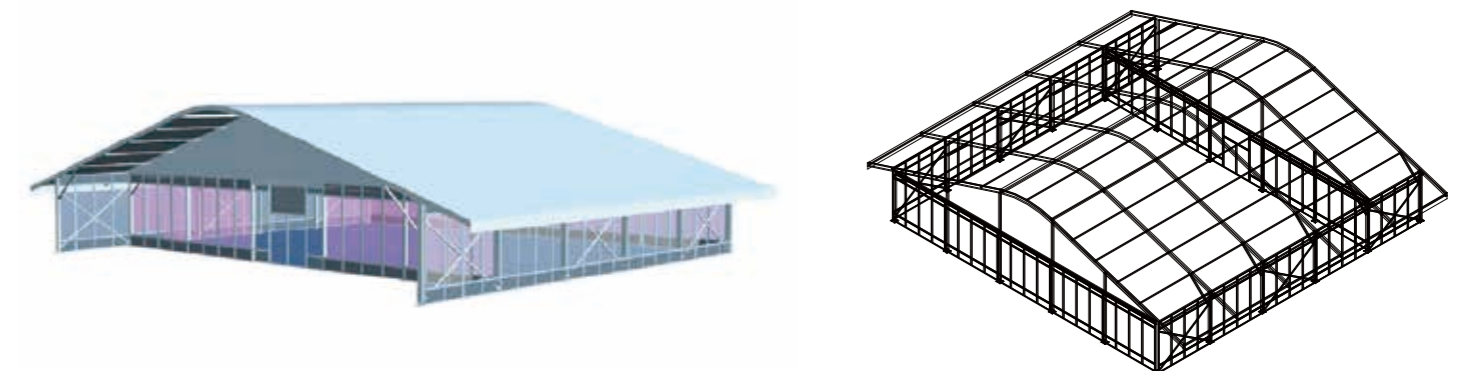
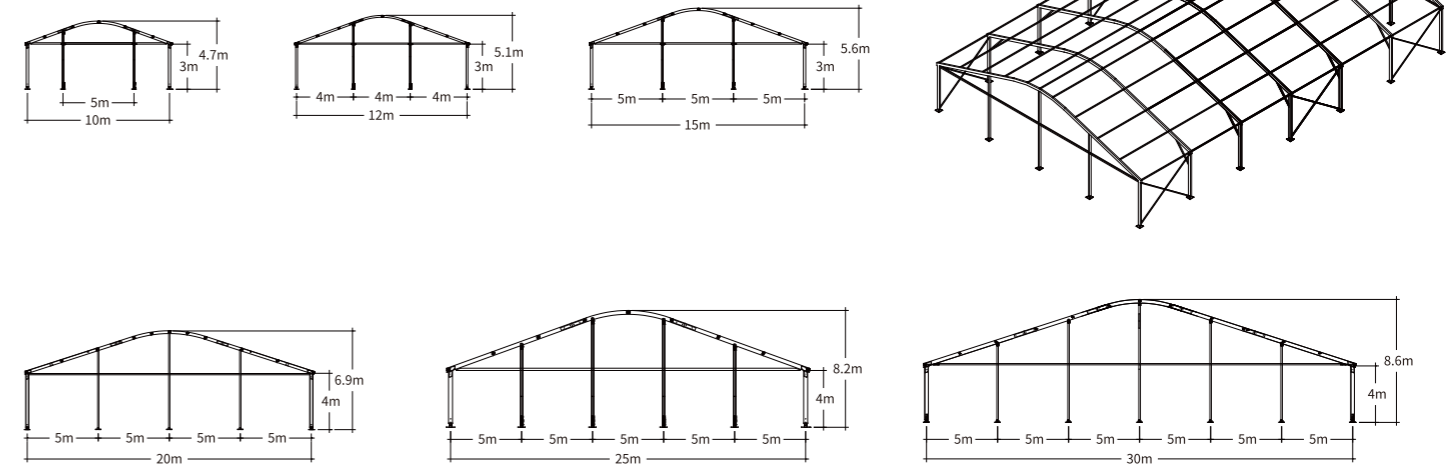
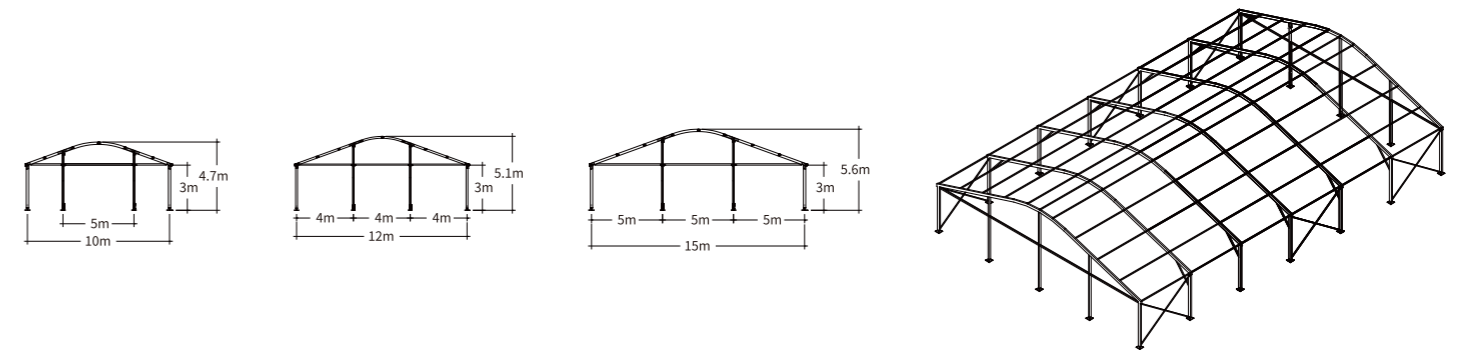

多边形篷房

POLYGON TENT

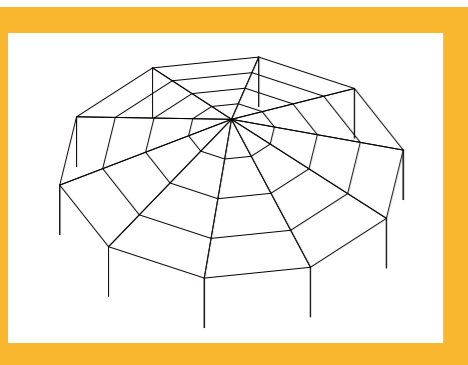

尺寸 Size	边高 Eave height	总高 Total height
直径16m	3m	5.92m
直径20m	4m	7.23m
直径25m	4m	8.0m
直径30m	4m	8.8m

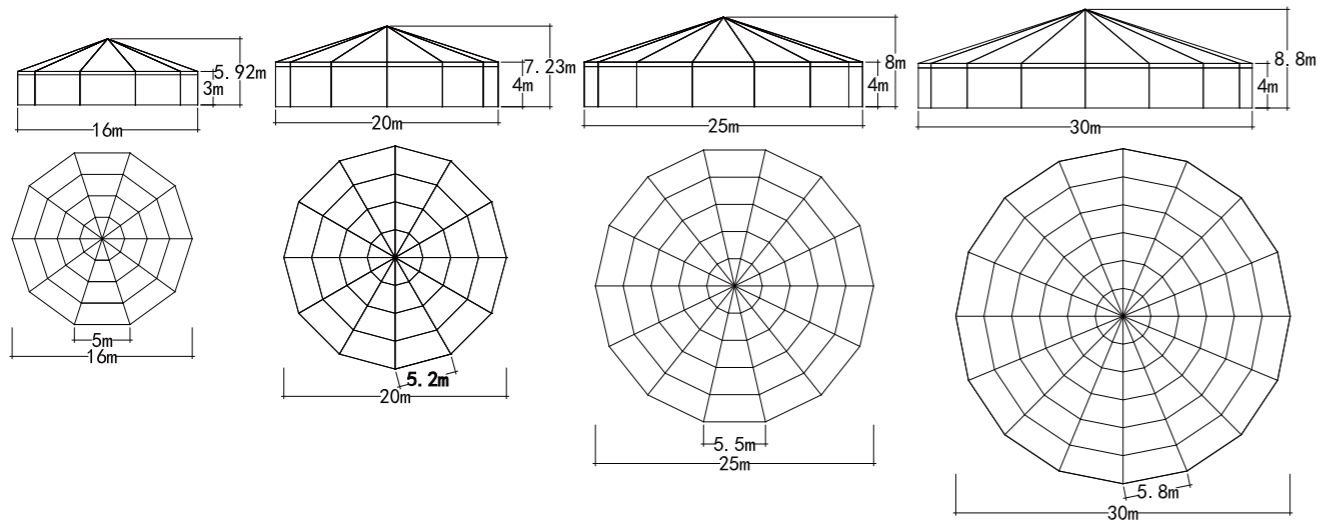

CURVE TENT 弯柱篷房

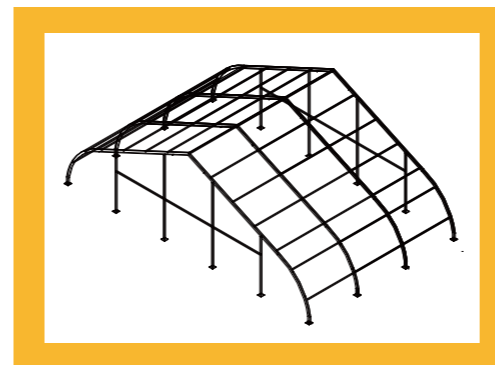

跨度 Span	间隔 Bay distance	边高 Eave height	总高 Total height
15m	5m	4.0m	7.2m
20m	5m	4.0m	8.4m
25m	5m	4.0m	9.6m
30m	5m	4.0m	10.7m
40m	5m	4.0m	13.1m

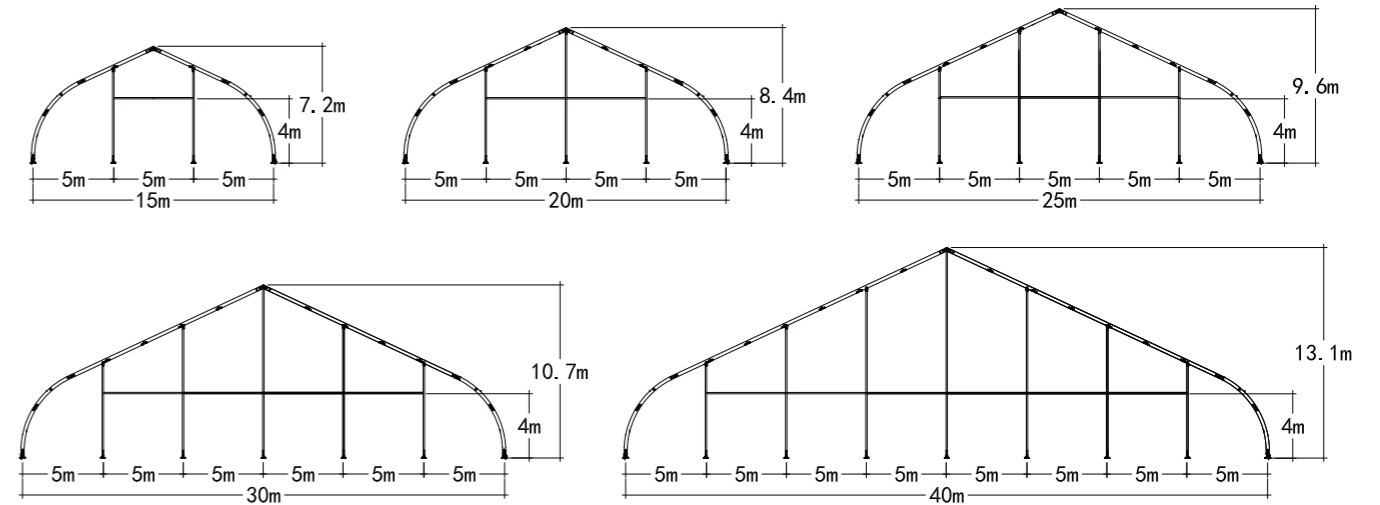

组合篷房 MIXED TENT

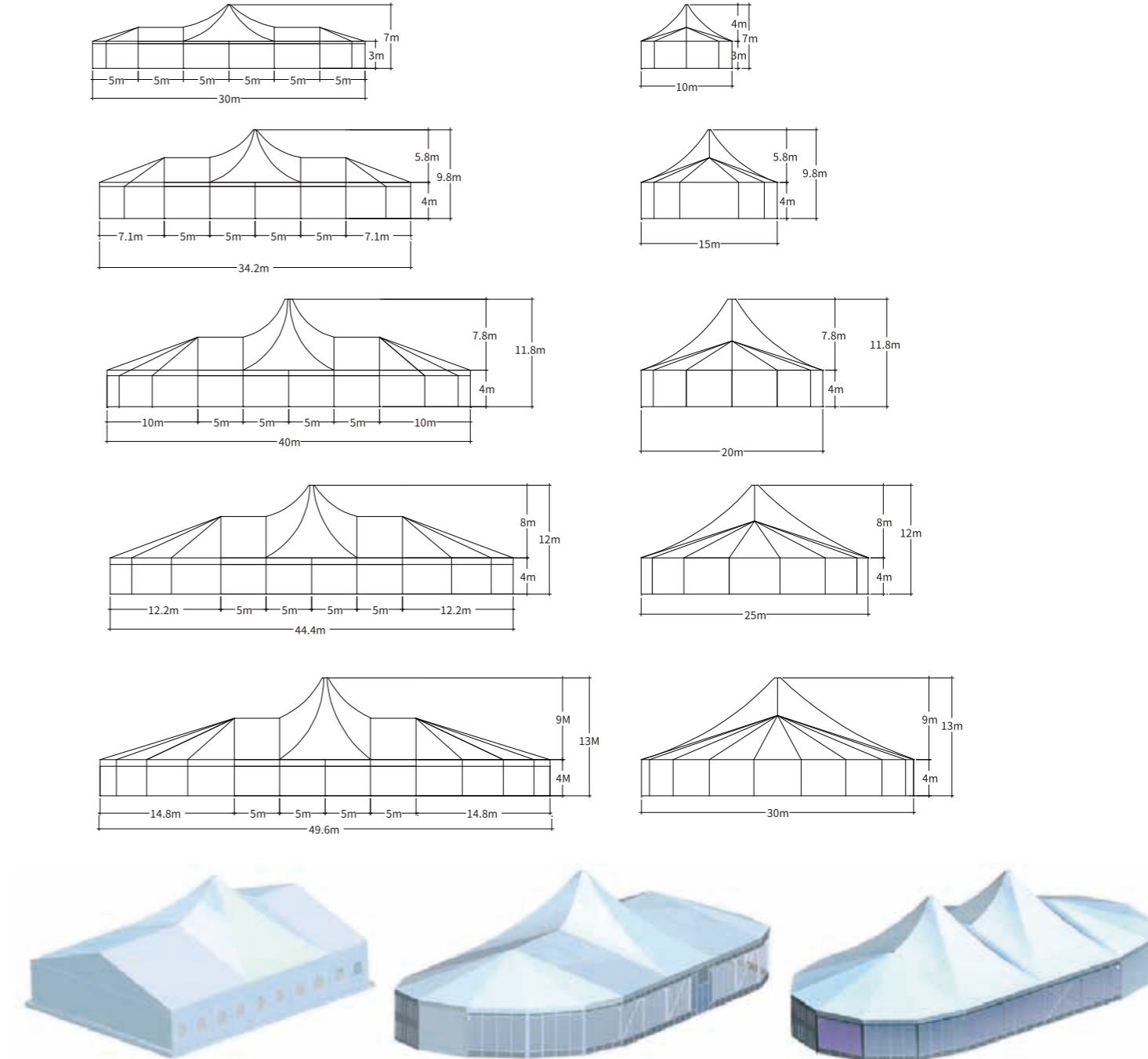
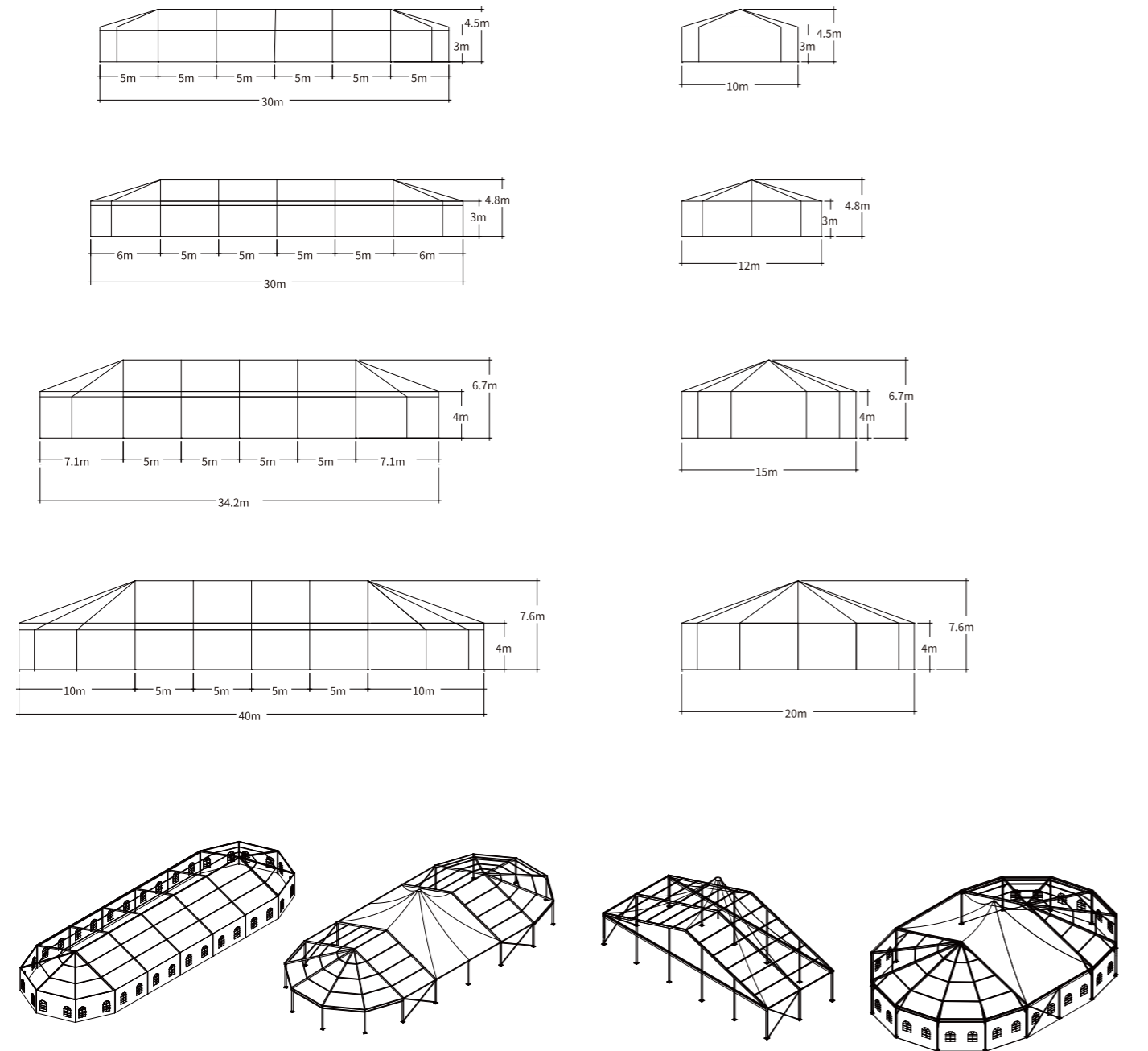

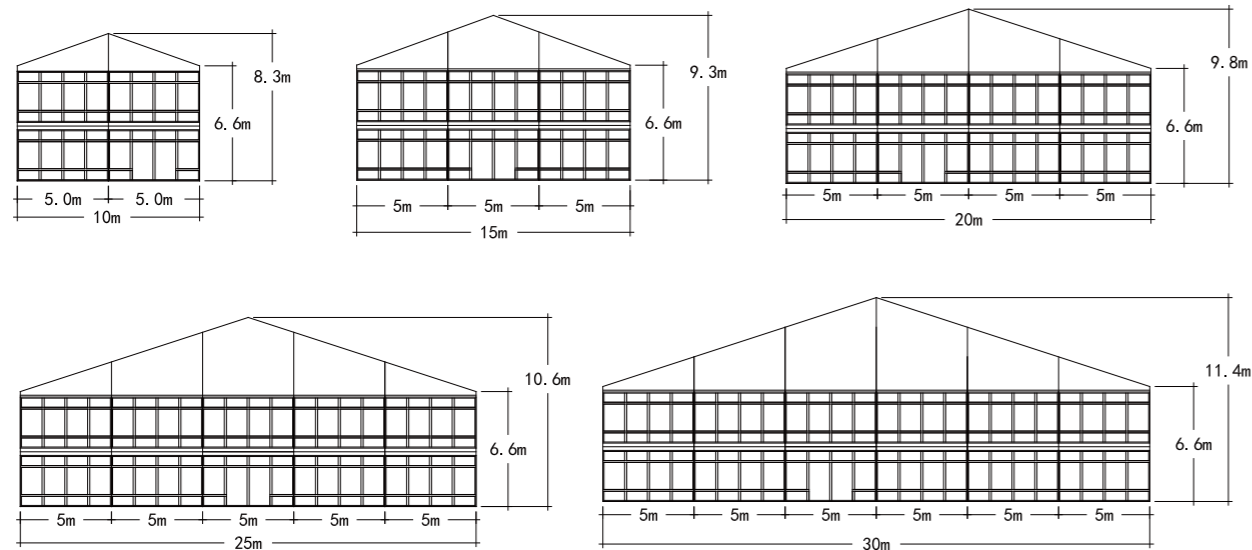
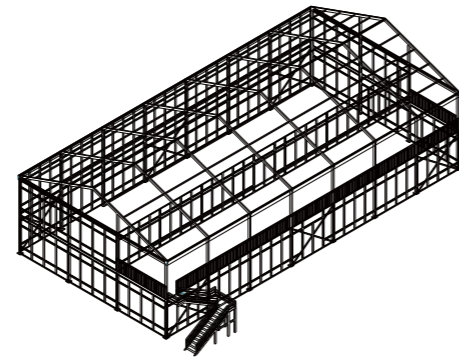
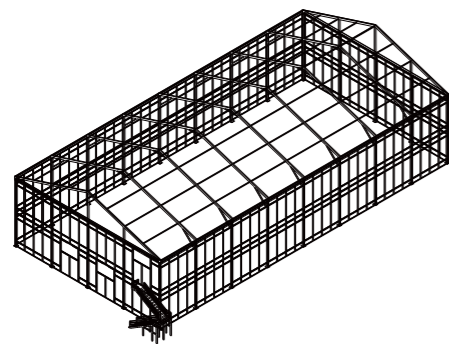
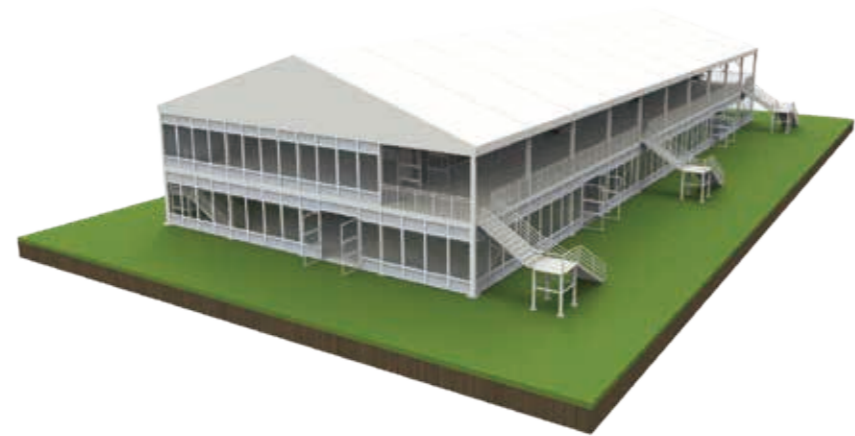

双层加高篷顶设计

- 使用空间大
- 造型独特
- 多功能用途

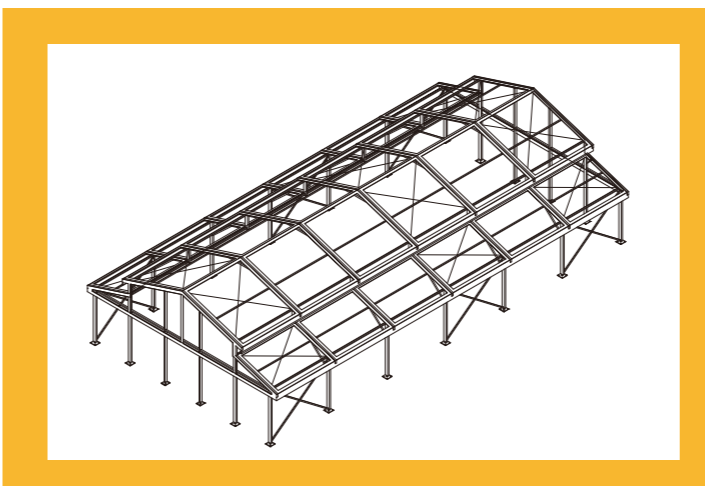

- 用途：活动、婚礼、婚庆、喜宴
- 规格：可定制尺寸、篷布颜色
- 管材：高强度铝合金
- 篷布：可根据客人选择
- 优点：因基新颖独特的造型吸人眼球，相比传统A字顶帐篷，外观更加美观。
- application: For events, weddings, wedding celebrations, and banquet dinners
- Specifications: Customizable sizes and canopy fabric colors
- Frame Material: High-strength aluminum alloy
- Canopy Fabric: Selectable according to customer preference
- Advantages: Its innovative and unique design catches the eye, and its appearance is more aesthetically pleasing compared to traditional A-frame tents.

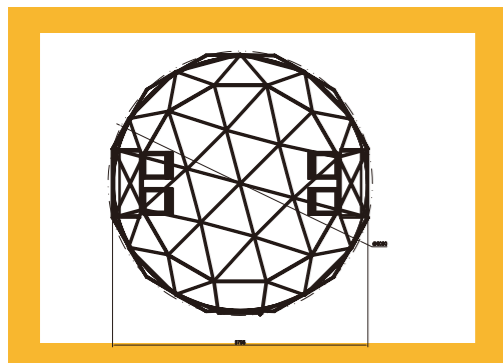
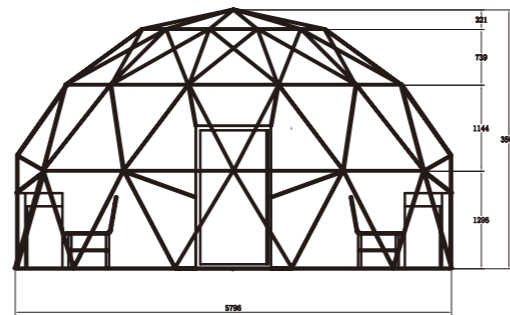
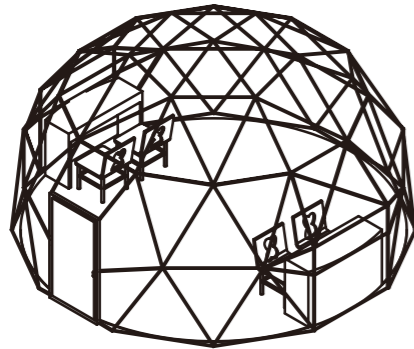
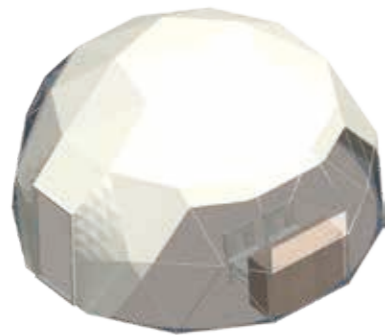

直径 Diameter	顶高 Ridge Height	室内面积 Area
6m	3.5m	28m ²
7m	4.0m	38m ²
8m	4.5m	50m ²
10m	5.0m	78m ²
12m	6.0m	113m ²
15m	7.0m	176m ²
20m	8.0m	314m ²

*注：以上数据为人工测量，存在误差请以实物为准
 *PS: The above data is based on manual measurement, and there may be errors.
 Please refer to the actual item for accuracy.



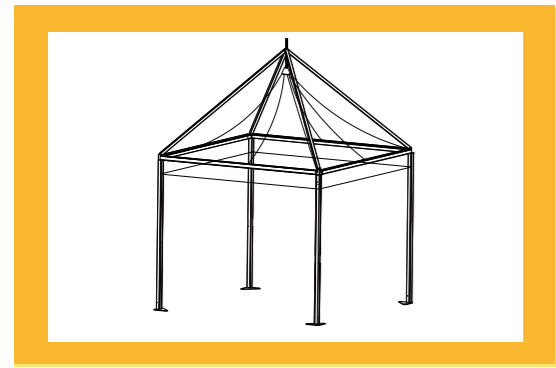
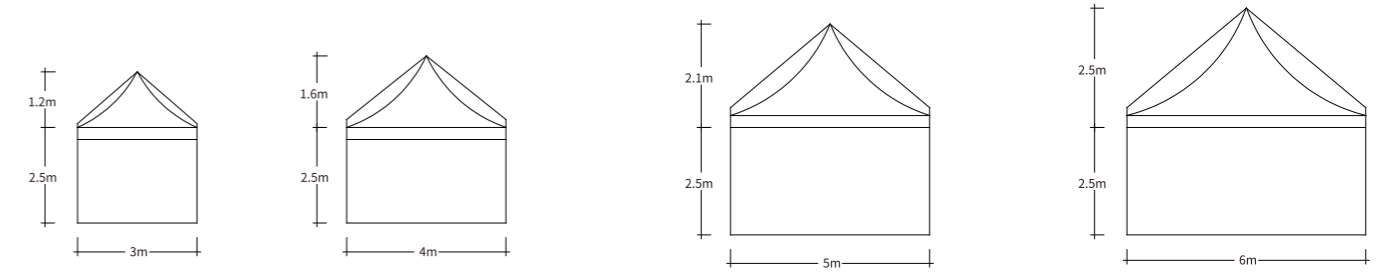
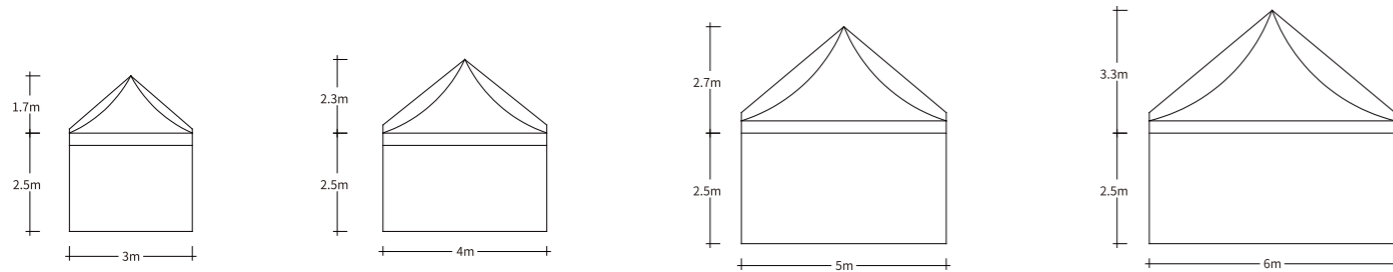

尺寸 Size	边高 Eave height	总高 Total height	主要型材 Main profile
3x3m	2.5m	4.2m	65x65x2.5mm
4x4m	2.5m	4.8m	65x65x2.5mm
5x5m	2.5m	5.2m	65x65x2.5mm
6x6m	2.5m	5.8m	65x65x2.5mm

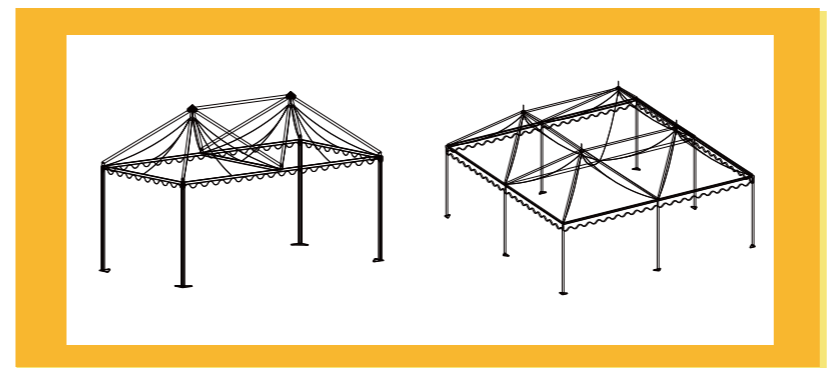

尺寸 Size	边高 Eave height	总高 Total height	主要型材 Main profile
3x3m	2.5m	3.7m	77x70x2.5mm
3x6m	2.5m	3.7m	77x70x2.5mm
4x4m	2.5m	4.1m	77x70x2.5mm
4x8m	2.5m	4.1m	77x70x2.5mm
5x5m	2.5m	4.6m	77x70x2.5mm
5x10m	2.5m	4.6m	77x70x2.5mm
6x6m	2.5m	5.0m	77x70x2.5mm
6x12m	2.5m	5.0m	77x70x2.5mm



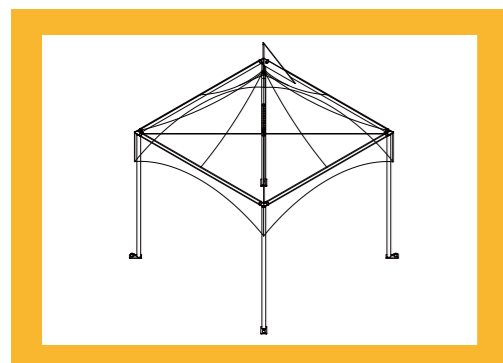
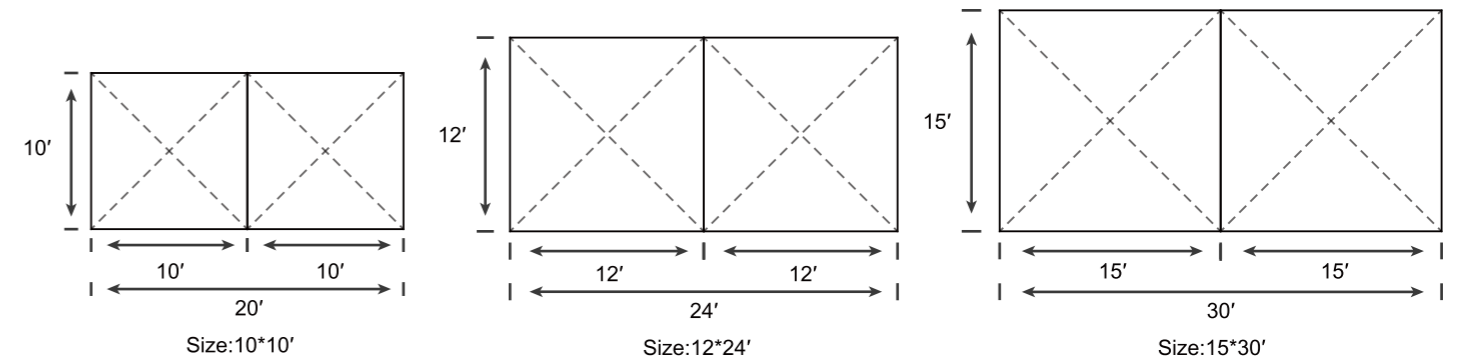
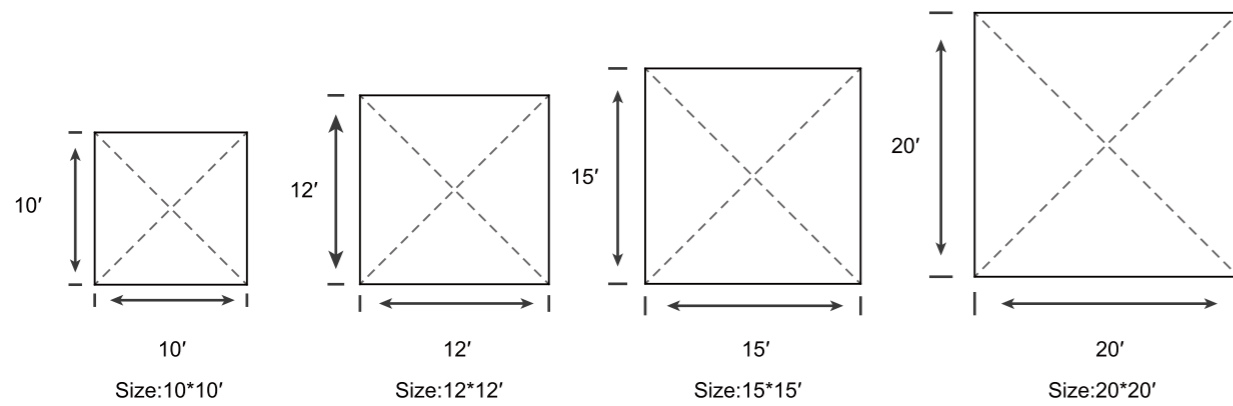

尺寸 Size	边高 Eave height	总高 Total height	主要型材 Main profile
10'x10' (3x3m)	8.2' (2.5m)	4.38m	φ63.5x2.5mm
12'x12' (3.65x3.65m)	8.2' (2.5m)	4.38m	φ63.5x2.5mm
15'x15' (4.5x4.5m)	8.2' (2.5m)	5.55m	φ63.5x2.5mm
20'x20' (6x6m)	8.2' (2.5m)	5.63m	φ63.5x2.5mm

*注: 总高包括旗子高度
*PS: The total height includes the flag height

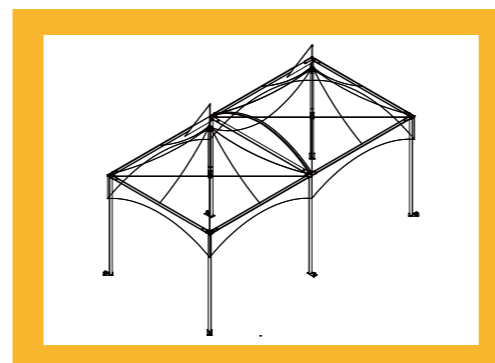

尺寸 Size	边高 Eave height	总高 Total height	主要型材 Main profile
10'x20' (3x6m)	8.2' (2.5m)	4.38m	φ63.5x2.5mm
12'x24' (3.65x7.3m)	8.2' (2.5m)	4.64m	φ63.5x2.5mm
15'x30' (4.5x9m)	8.2' (2.5m)	5.55m	φ63.5x2.5mm
20'x40' (6x6m)	8.2' (2.5m)	5.63m	φ63.5x2.5mm

*注: 总高包括旗子高度
*PS: The total height includes the flag height

锥顶篷

PAGODA TENT

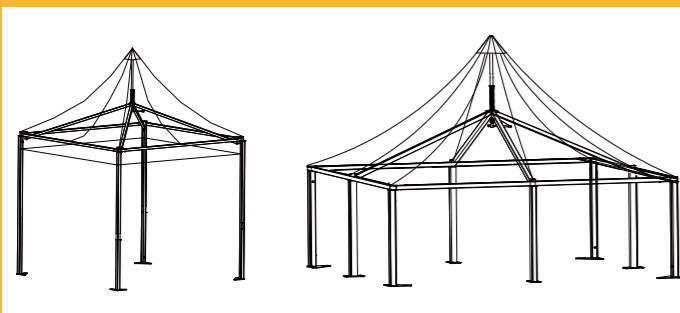
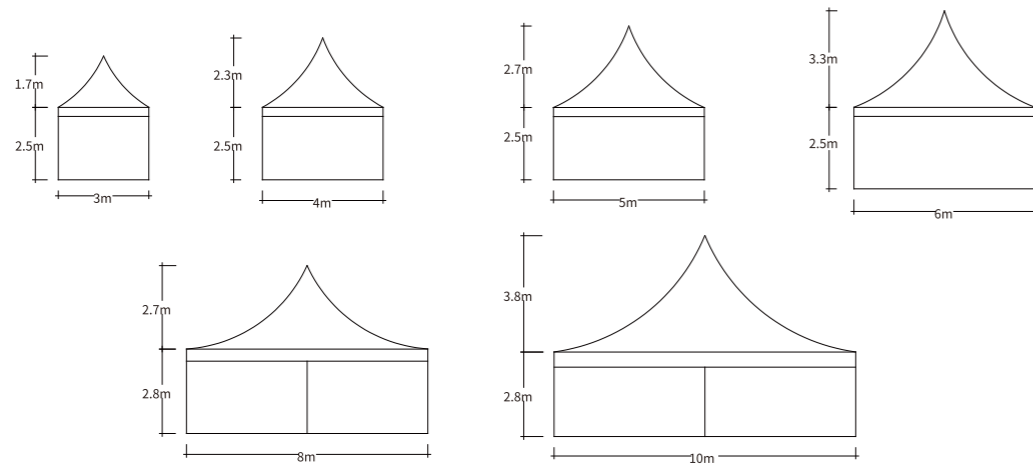

尺寸 Size	边高 Eave height	总高 Total height	主要型材 Main profile
3*3m	2.5m	4.2m	65x65x2.5mm
4*4m	2.5m	4.8m	65x65x2.5mm
5*5m	2.5m	5.2m	65x65x2.5mm
6*6m	2.5m	5.8m	65x65x2.5mm
8*8m	2.8m	5.5m	121x68x3.0mm
10*10m	2.8m	6.6m	121x68x3.0mm

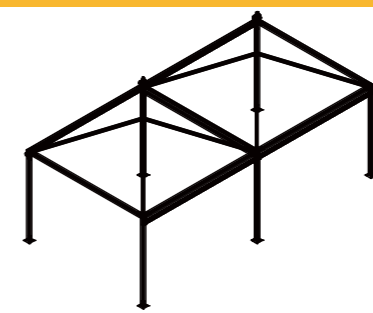

尺寸 Size	边高 Eave height	总高 Total height	主要型材 Main profile
3x6m	2.5m	4.2m	65x65x2.5mm
4x8m	2.5m	4.8m	65x65x2.5mm
5x10m	2.5m	5.5m	65x65x2.5mm
6x12m	2.5m	6.0m	65x65x2.5mm

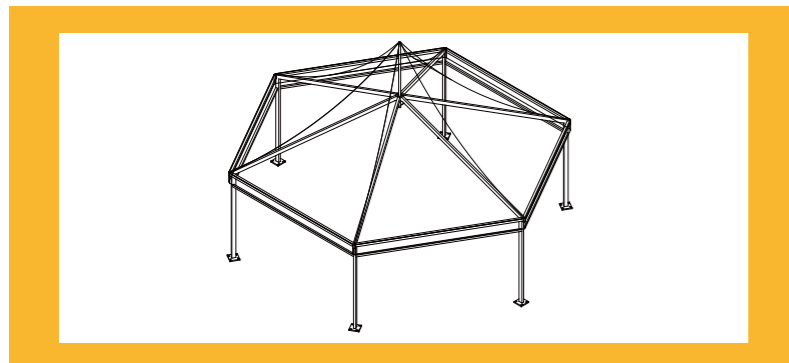
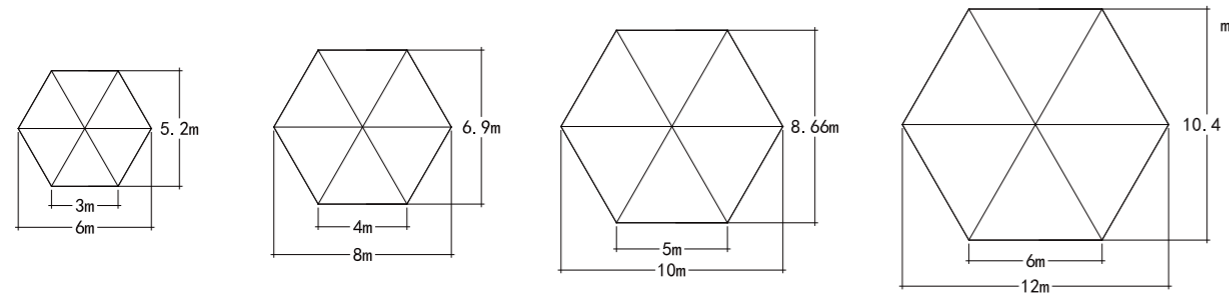
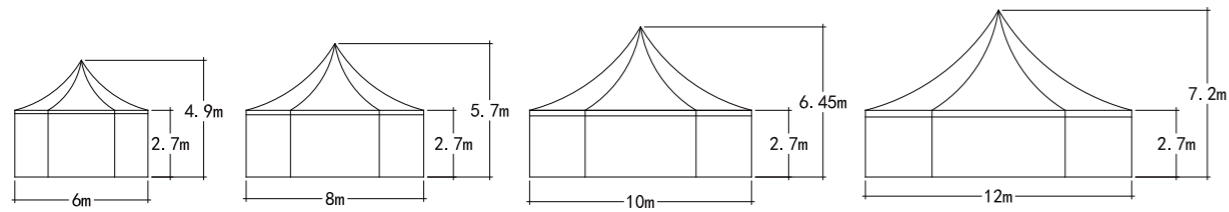

尺寸 Size	边高 Eave height	总高 Total height	主要型材 Main profile
6m	2.7m	4.9m	84x48x2.6mm
8m	2.7m	5.7m	84x48x2.6mm
10m	2.7m	6.45m	121x68x3.0mm
12m	2.7m	7.2m	121x68x3.0mm

尺寸 Size	尺寸 Size	尺寸 Size
20'x20'	30'x30'	40'x40'
20'x30'	30'x40'	40'x50'
20'x40'	30'x50'	40'x60'
20'x50'	30'x60'	40'x80'
20'x60'	30'x70'	40'x90'
20'x70'	30'x80'	40'x100'
20'x80'	30'x90'	40'x120'

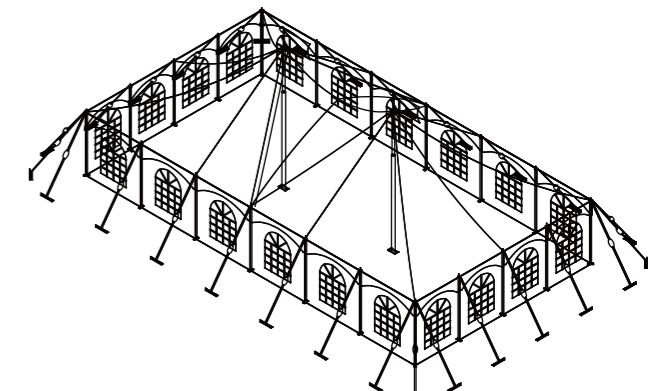



尺寸 Size	尺寸 Size	尺寸 Size	尺寸 Size	尺寸 Size	尺寸 Size
10'x10'	12'x12'	15'x15'	20'x20'	30'x30'	40'x40'
10'x20'	12'x15'	15'x20'	20'x30'	30'x40'	40'x50'
10'x30'	12'x20'	15'x30'	20'x40'	30'x50'	40'x60'
10'x40'	12'x24'	15'x40'	20'x50'	30'x60'	40'x80'
10'x50'	12'x30'	15'x50'	20'x60'	30'x70'	40'x90'
10'x60'	12'x50'	15'x60'	20'x70'	30'x80'	40'x100'
10'x70'		15'x70'	20'x80'	30'x90'	40'x120'
10'x80'		15'x80'			
主要材料: $\phi 50 \times 3.0\text{mm}$ Main material					主要材料: Main material 98.5*50.8*3.2mm

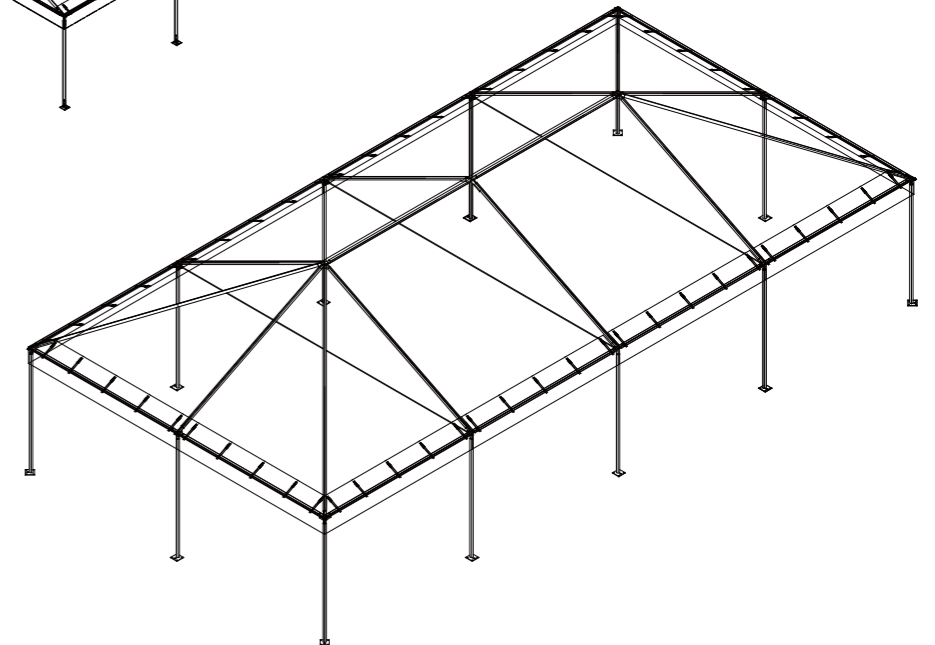
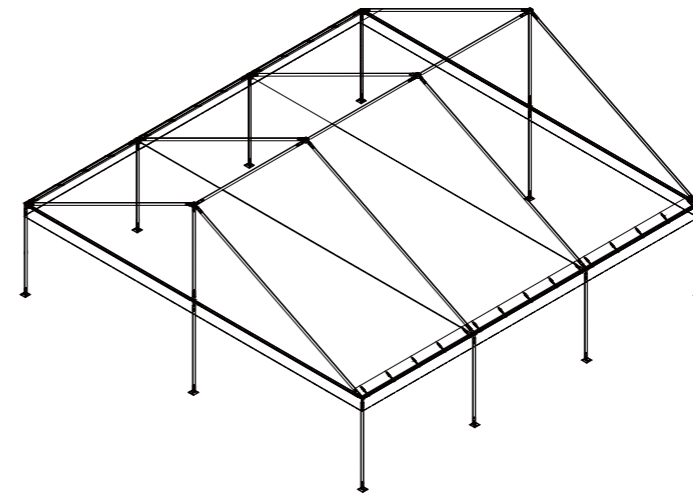



ABS墙体 ABS wall



玻璃墙 Glass wall



玻璃门 Glass door



布幔 Lining



布幔 Lining



布幔 Lining



地板 Flooring



地板 Flooring



排水槽 Rain gutter



膨胀螺丝 Expandable screw



地钉 Steel nails



起钉器 Steel nail puller



喷涂 Printing



灯 Light



承重盘 Weight plate

高强度铝合金 High-strength aluminum alloy 坚固耐用不变形 Sturdy and durable, with no deformation

- 耐腐蚀性强 Strong corrosion resistance
- 硬度强 high hardness
- 安全阻燃 Safe and flame retardant

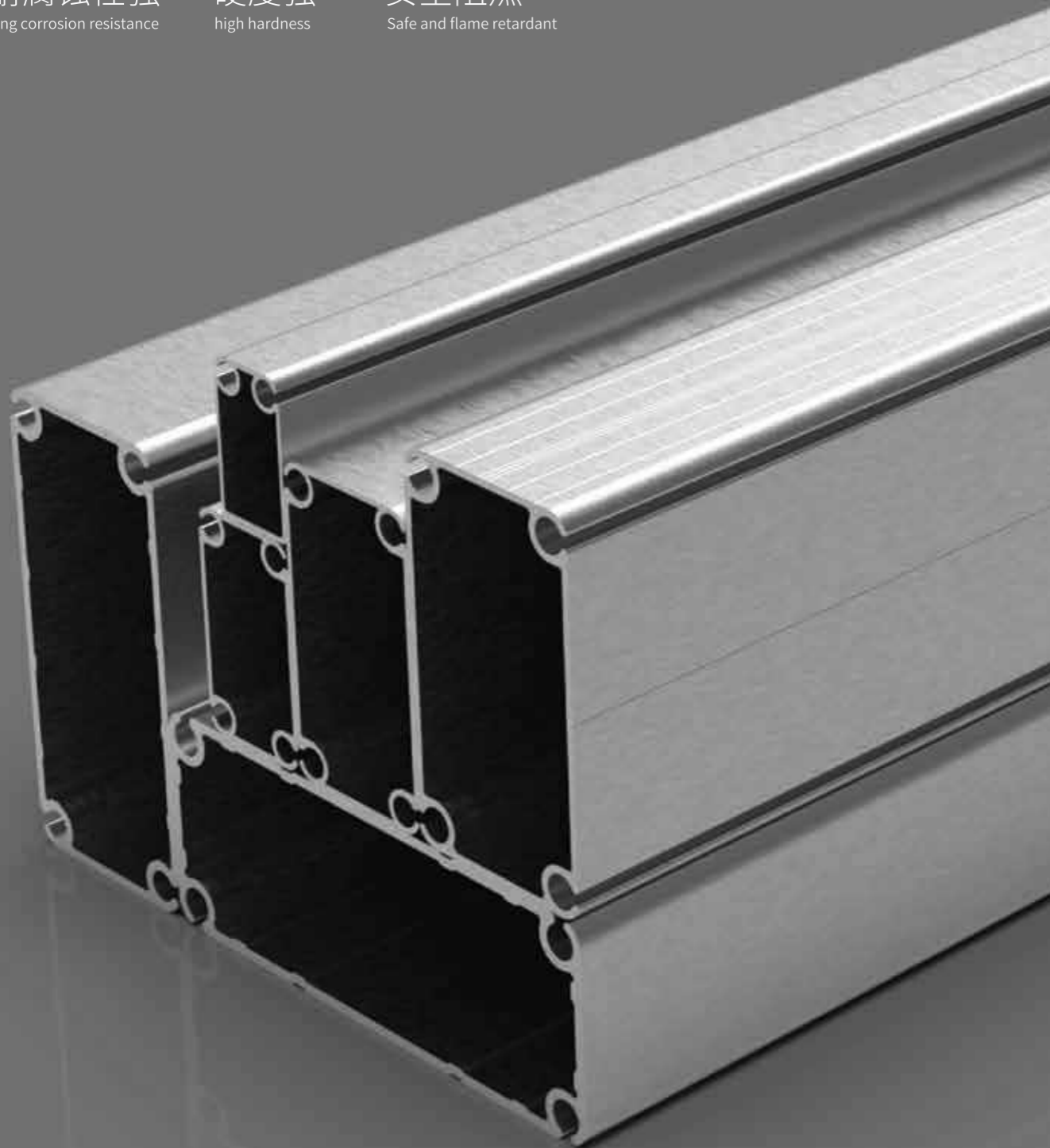

篷房材料

Tent Material



50M Tent: 350x125mm
(适用于跨度为50M的篷房)
(Suitable for tents with a span of 40M)



35/40M Tent: 300x125mm
(适用于跨度为35/40M的篷房)
(Suitable for tents with a span of 35M)



25/30M Tent: 255x115mm
(适用于跨度为25/30M的篷房)
(Suitable for tents with a span of 25/30M)



20M Tent: 203x110mm
(适用于跨度为20/25M的篷房)
(Suitable for tents with a span of 20/25M)



15/18M Tent: 166x88mm
(适用于跨度为15/18M的篷房)
(Suitable for tents with a span of 15/18M)



12M Tent: 121x68mm
(适用于跨度为12M的篷房)
(Suitable for tents with a span of 12M)



10M Tent: 84x48mm
(适用于跨度等于或小于10M的篷房)
(Suitable for tents with a span of 10M or less)



50*50mm



70*70mm



60*60mm



40*40mm



75*85mm/100*85mm



100*85mm



玻璃墙码连接管



小横梁小耳朵



三角布连接管



h挂杆

锥顶篷和吊顶篷材料

Tent Material



65*65mm



46*46mm

XL吊顶篷材料

Tent Material



77*70mm



φ60mm



φ60mm



篷房顶布 Tent roof fabric(850g/m², 0.6mm thickness)



篷房围布 Tent wallside fabric(650g/m², 0.5mm thickness)

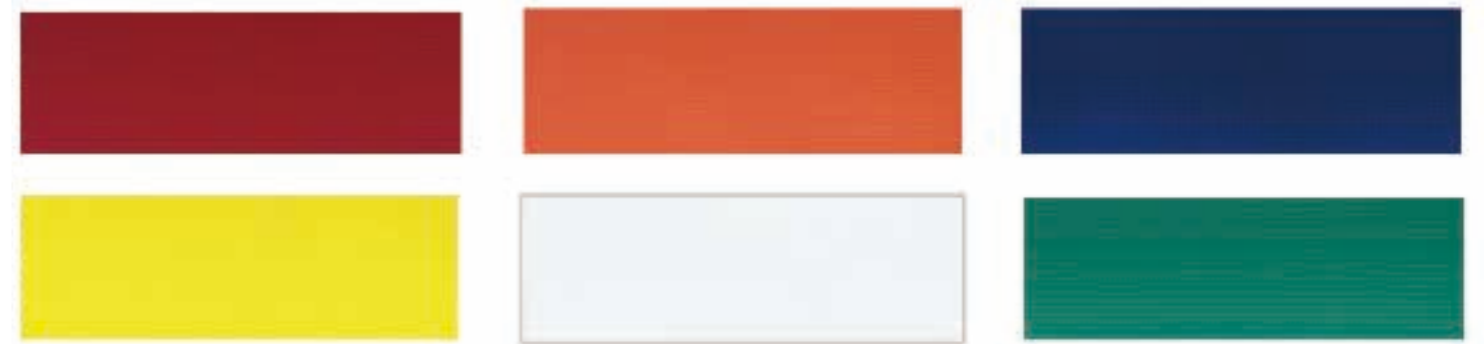

其他布料 Other fabric(550g/m², 0.45mm thickness)



优质篷房布料

High-quality tent fabric

阻燃 防水 更严格的选择PVC刀刮布

Flame retardant, waterproof, an even stricter choice: PVC knife-coated fabric.

